

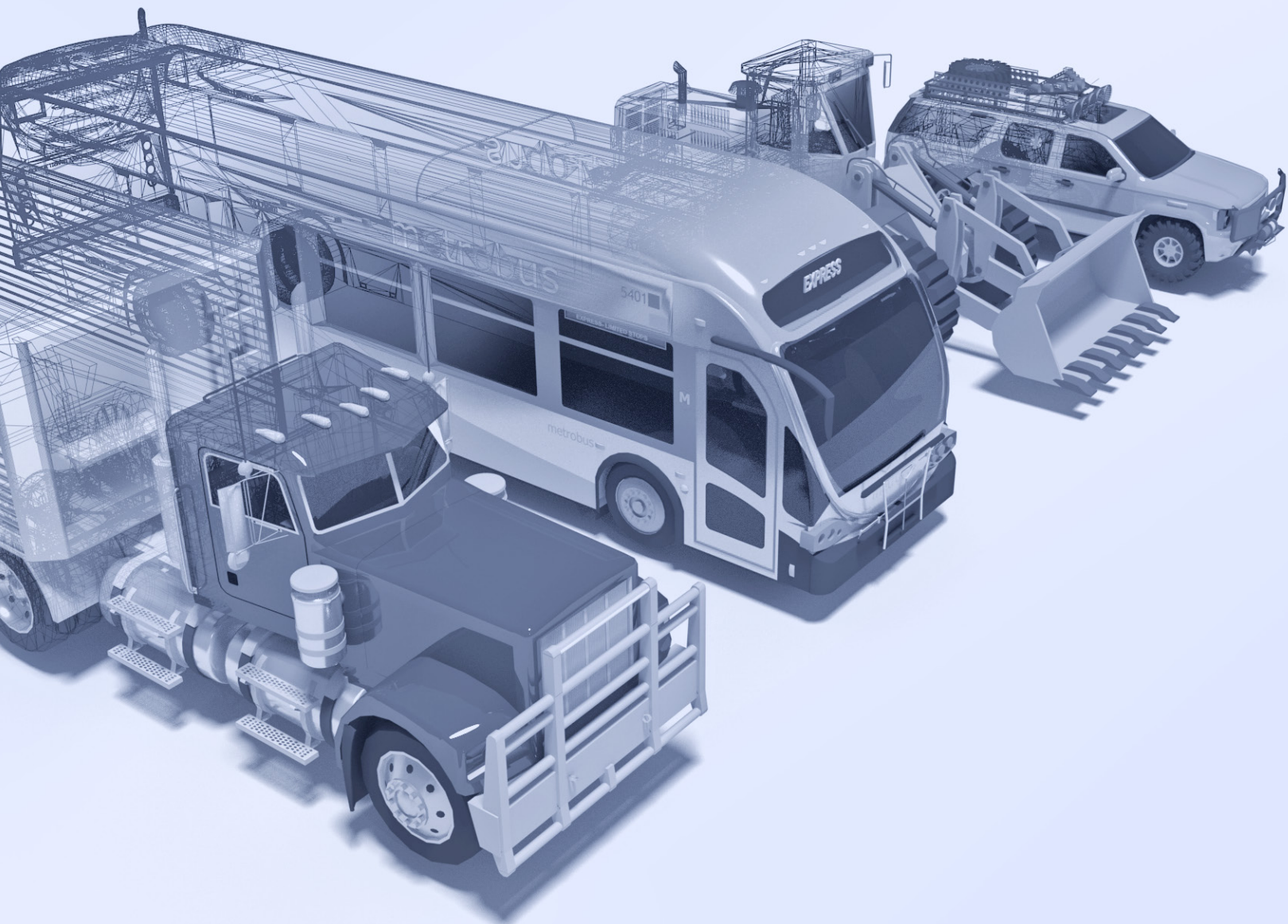

Automation

# DOT Fittings

FOR TRANSPORTATION





---

Meets all requirements for Federal DOT  
Standard 571.106 49 CFR Ch. V

---

Meets all requirements for SAE J2494-1,  
SAE J2494-3, and SAE J1131.

---

Complies with the performance requirements of  
DOT FMVSS 571.106, SAE J2494-3, SAE J1131  
when used with SAE J844 type A & B nylon tubing.

---

Designed for use on all pneumatic circuits and assemblies  
except between the frame and axle, or between a  
towed and towing vehicle.

---

Camozzi ND6000 DOT/SAE rated fittings are designed for use on all pneumatic circuits except where prohibited by the US Department of Transportation such as in the use of air brake assemblies between frame and axle or between a towed or towing vehicle. Camozzi ND6000 DOT/SAE rated fittings are intended for use only in strict compliance with DOT FMVSS (ARTICLE or SECTION)571.106 and SAE J2494-3.



# Camozzi Transportation

The Camozzi Group is a vertically integrated global company composed of multiple companies and divisions with over 50 years of experience. Camozzi Transportation is able to rely on this wealth of engineering and manufacturing experience to produce the highest quality components and solutions for the transportation sector.

---

Vertically Integrated  
Global Company

---

Engineering Expertise

---

Manufacturing Mastery

---

Transportation Focused

---

Truck & Trailer is one of the most diverse transportation sectors. This is made apparent when you consider the many different operating and environmental conditions that can exist; the evolving standards to reduce polluting emissions and the ever-present requirement for safety, comfort, energy efficiency, all of which are now regarded as prerequisites.

It is for these reasons that Camozzi components have been designed and tested to perform in many different scenarios, for example, while being subjected to intense vibration and wide variations in temperature. Fittings are often viewed as a thoughtless component due to the clearly defined testing standards. However, Camozzi has exceeded the required DOT and SAE standards. Camozzi has also engineered a fitting that is designed to last longer and outperform the competition under the harshest conditions every season.

Valves are supplied into this sector to control cooling fluids and suspension systems. Onboard FRL assemblies and fittings are also available along with cylinders for the actuation of lifting and coupling systems. Customized solutions to satisfy specific requirements or integrated mechatronic systems can also be supplied that can be quickly configured.



# Camozzi Transportation

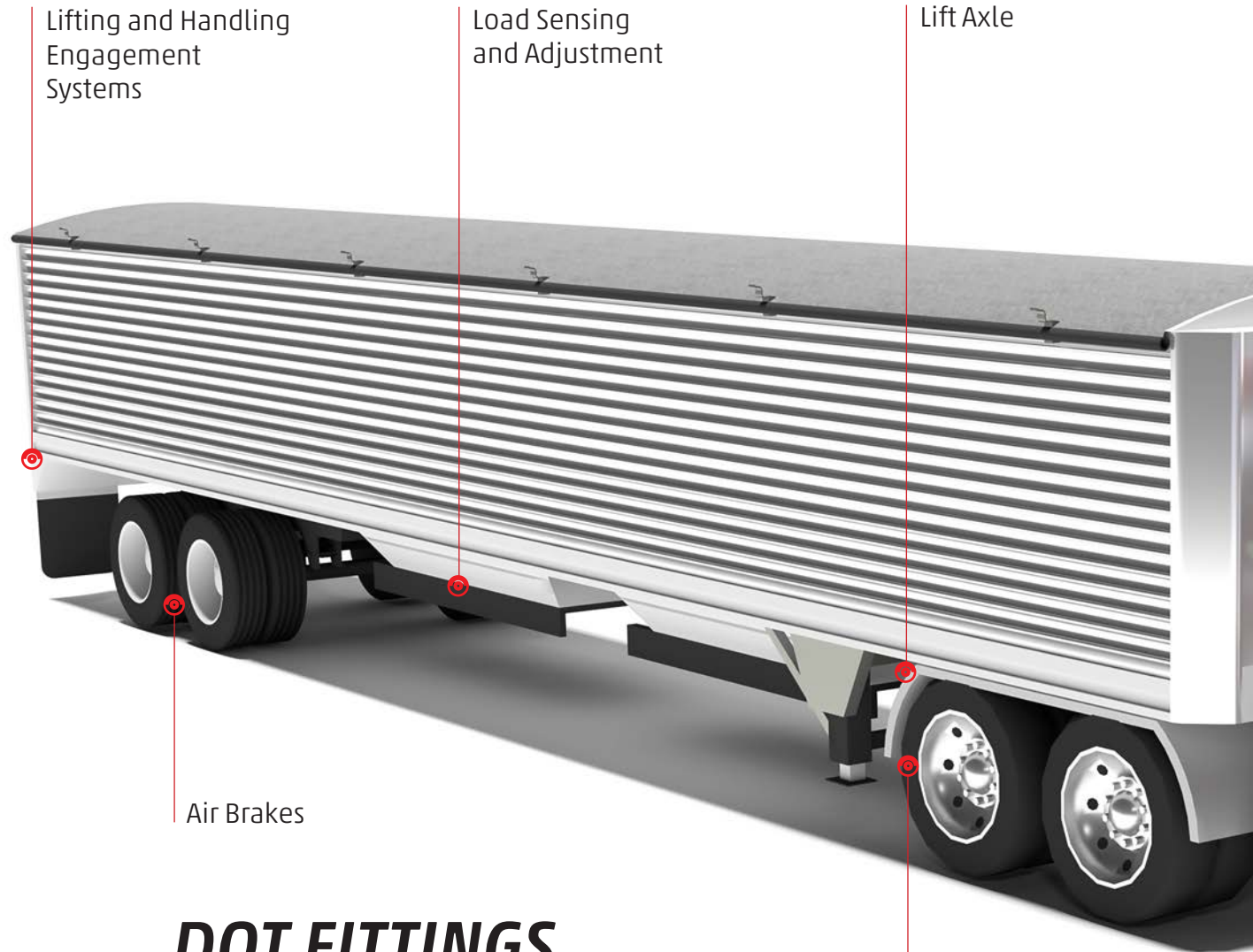

Lifting and Handling Engagement Systems

Load Sensing and Adjustment

Lift Axle

Air Brakes

## DOT FITTINGS

**Low Temp O-rings**  
-58° - 200°F rated o-rings

**Compact Design**  
Provides space savings on manifolds and within compact enclosures

**Full Flow Design**  
Internally shaped for non-restrictive air flow

**Brass Body**  
Impact resistance for durability and safety in the harshest conditions and most demanding applications

**Nickel Plating**  
Nickel-plated brass body and collet provide additional corrosion protection to withstand the harshest conditions

**Thread Sealant**  
Preapplied sealant decreases installation time

**Multigrip collet**  
Specially engineered collet for superior tube retention

**Tube Support**  
Durable fixed tube insert for exceptional sideload support

**Push-to-Connect Collet**  
Faster and easier installation and maintenance than compression style fittings

**One Piece Collet**  
Specially engineered one-piece collet designed to provide superior hold under the worst conditions

**Swivel**  
Reinforced swivel design for durability, safety and reliability

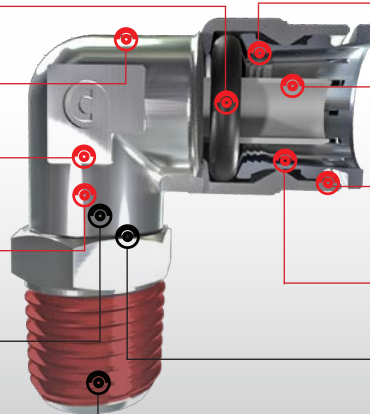

Tire Inflation

...connecting transportation

Transmissions

Cab Controls

Engine



Air Tanks

Fuel Systems

Cooling Systems

# Nickel-Plated Brass DOT Fittings NPTF/Inch Series ND

Tube Diameter OD : 5/32", 1/4", 3/8", 1/2", 5/8", 3/4"

Thread Type : 1/8", 1/4", 3/8", 1/2", 3/4" NPTF



The US Department prohibits the use of air brake tubing assemblies between the frame and axle or between a towed and towing vehicle.

- Meets all requirements for Federal DOT Standard 571.106\* 49 CFR Ch. V
- Meets all requirements for SAE J2494-3
- Temperature Range: -58°F to 200°F
- Electrolytic Nickel Plated brass body with a low temperature BUNA-N O-ring
- For use with SAE J844 A & B Nylon® tubing
- Compressed air applications
- Thread pre-coated with sealant

## GENERAL DATA

<b>Material</b>	Electrolytic Nickel-plated brass OT58 UNI 5705, Tube-support/insert in glass-reinforced Nylon
<b>Collet</b>	Brass OT58, nickel plated
<b>O-ring</b>	Low temperature Buna-N (NBR)
<b>Threads</b>	10/32 UNF, 1/8", 1/4", 3/8", 1/2", 3/4" NPTF
<b>Temperature Range</b>	-58°F - 200°F
<b>Operating pressure</b>	0 - 275 psi (3/4" tube size operating pressure = 0 - 175 psi)
<b>Fluid</b>	Compressed air [for other types of fluid please contact your local Camozzi branch]
<b>Tube diameter</b>	5/32", 1/4", 3/8", 1/2", 5/8", 3/4" OD

Fittings Model ND6510

Male Connector

DIMENSIONS (in inches)										
Mod.	A OD	D NPTF	C	F	G	H	L	SW	SW1	
ND6512 04-32	1/4	10/32UNF	0.520	0.307	0.346	0.157	0.787	0.315	0.079	
ND6512 53-32	5/32	10/32UNF	0.606	0.461	0.520	0.157	0.866	0.472	0.079	
ND6510 53-02	5/32	1/8	0.520	0.346	0.548	0.315	0.748	0.472	0.098	
ND6510 53-04	5/32	1/4	0.520	0.346	0.639	0.472	0.906	0.551	0.098	
ND6510 04-02	1/4	1/8	0.606	0.461	0.548	0.315	0.925	0.472	0.157	
ND6510 04-04	1/4	1/4	0.606	0.461	0.639	0.472	1.043	0.551	0.157	
ND6510 04-06	1/4	3/8	0.606	0.461	0.868	0.472	1.063	0.748	0.157	
ND6510 04-08*	1/4	1/2	0.606	0.461	1.004	0.610	0.906	0.866	0.157	
ND6510 06-02	3/8	1/8	0.787	0.606	0.776	0.315	1.201	0.669	0.197	
ND6510 06-04	3/8	1/4	0.787	0.606	0.776	0.472	1.358	0.669	0.276	
ND6510 06-06	3/8	3/8	0.787	0.606	0.868	0.472	1.161	0.748	0.276	
ND6510 06-08	3/8	1/2	0.787	0.606	1.005	0.610	1.181	0.866	0.276	
ND6510 08-04	1/2	1/4	0.787	0.736	0.868	0.472	1.358	0.748	0.276	
ND6510 08-06	1/2	3/8	0.787	0.736	0.868	0.472	1.319	0.748	0.394	
ND6510 08-08	1/2	1/2	0.787	0.736	1.005	0.610	1.280	0.866	0.394	
ND6510 08-12	1/2	3/4	0.787	0.736	1.233	0.610	1.240	1.063	0.394	
ND6510 10-06	5/8	3/8	0.976	0.925	1.096	0.472	1.575	0.945	0.394	
ND6510 10-08	5/8	1/2	0.976	0.925	1.096	0.610	1.693	0.945	0.512	
ND6510 12-06*	3/4	3/8	27.8	1.055	1.232	0.472	1.594	1.063	0.394	
ND6510 12-08	3/4	1/2	1.094	1.055	1.233	0.610	1.732	1.063	0.512	
ND6510 12-12	3/4	3/4	1.094	1.055	1.233	0.610	1.417	1.063	0.512	

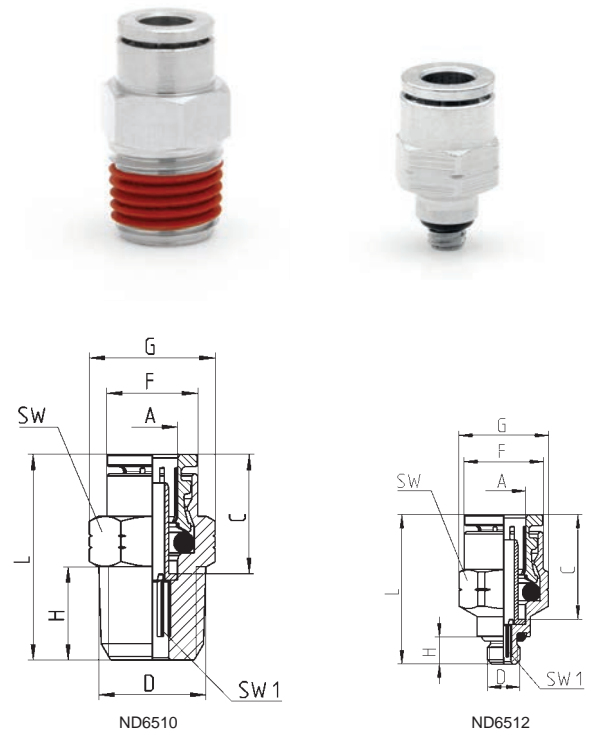

\*Produced Upon Request  
Contact Camozzi USA for Availability

Fittings Model ND6520

Male Swivel Elbow

DIMENSIONS (in inches)										
Mod.	A OD	D NPTF	C	F	E	H	M	SW	SW1	
ND6522 04-32	1/4	10/32UNF	0.606	0.500	0.531	0.157	0.807	0.354	0.394	
ND6520 53-02	5/32	1/8	0.520	0.354	0.650	0.315	0.689	0.315	0.472	
ND6520 53-04	5/32	1/4	0.520	0.354	0.689	0.472	0.689	0.315	0.551	
ND6520 04-02	1/4	1/8	0.606	0.500	0.669	0.315	0.807	0.354	0.472	
ND6520 04-04	1/4	1/4	0.606	0.500	0.709	0.472	0.807	0.354	0.551	
ND6520 04-06	1/4	3/8	0.606	0.500	0.689	0.472	0.807	0.354	0.748	
ND6520 04-08	1/4	1/2	0.606	0.500	0.876	0.610	0.807	0.354	0.866	
ND6520 06-02	3/8	1/8	0.787	0.650	0.787	0.315	1.043	0.512	0.551	
ND6520 06-04	3/8	1/4	0.787	0.650	0.827	0.472	1.043	0.512	0.551	
ND6520 06-06	3/8	3/8	0.787	0.650	0.807	0.472	1.043	0.512	0.748	
ND6520 06-08	3/8	1/2	0.787	0.650	0.886	0.610	1.043	0.512	0.866	
ND6520 06-12*	3/8	3/4	0.787	0.650	0.886	0.610	1.043	0.512	1.063	
ND6520 08-04	1/2	1/4	0.787	0.768	0.886	0.472	1.102	0.591	0.669	
ND6520 08-06	1/2	3/8	0.787	0.768	0.846	0.472	1.102	0.591	0.748	
ND6520 08-08	1/2	1/2	0.787	0.768	0.925	0.610	1.102	0.591	0.866	
ND6520 08-12	1/2	3/4	0.787	0.768	0.925	0.610	1.102	0.591	1.063	
ND6520 10-06	5/8	3/8	0.976	0.984	1.063	0.472	1.378	0.787	0.866	
ND6520 10-08	5/8	1/2	0.976	0.984	1.122	0.610	1.378	0.787	0.866	
ND6520 12-06*	3/4	3/8	1.094	1.122	1.043	0.472	1.437	0.945	0.945	
ND6520 12-08	3/4	1/2	1.094	1.122	1.181	0.610	1.437	0.945	0.945	
ND6520 12-12	3/4	3/4	1.094	1.122	1.181	0.610	1.437	0.945	1.063	

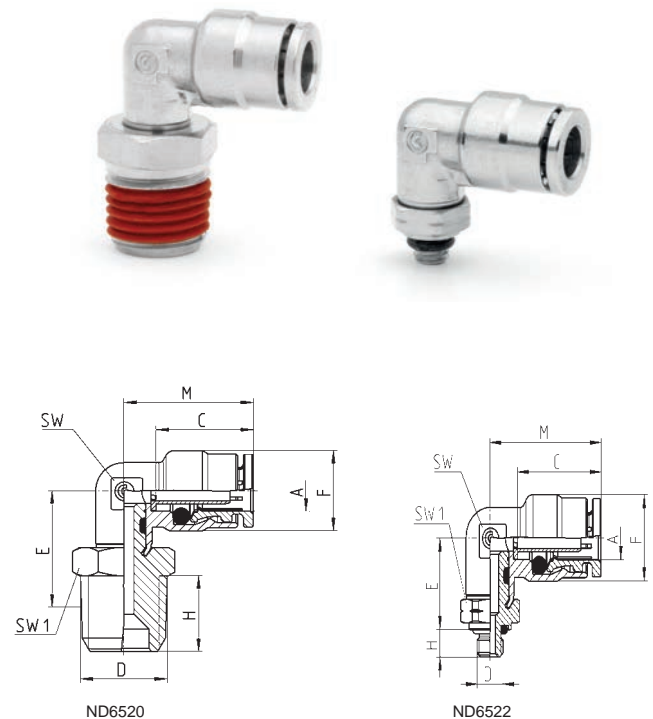

\*Produced Upon Request  
Contact Camozzi USA for Availability

**Fittings Model ND6500**

Male Non-Swivel Elbow

**DIMENSIONS (in inches)**

Model	A OD	D NPTF	C	F	E	H	M	SW
ND6500 04-02	1/4	1/8	0.606	0.500	0.472	0.354	0.807	0.354
ND6500 04-04	1/4	1/4	0.606	0.500	0.472	0.472	0.807	0.354
ND6500 04-06	1/4	3/8	0.606	0.500	0.531	0.512	0.906	0.472
ND6500 04-08*	1/4	1/2	0.606	0.500	0.728	0.630	0.807	0.591
ND6500 06-02	3/8	1/8	0.787	0.650	0.531	0.335	1.043	0.512
ND6500 06-04	3/8	1/4	0.787	0.650	0.551	0.492	1.043	0.512
ND6500 06-06	3/8	3/8	0.787	0.650	0.512	0.472	1.043	0.512
ND6500 06-08	3/8	1/2	0.787	0.650	0.728	0.630	1.063	0.591
ND6500 08-04	1/2	1/4	0.787	0.768	0.610	0.492	1.102	0.591
ND6500 08-06	1/2	3/8	0.787	0.768	0.571	0.492	1.102	0.591
ND6500 08-08	1/2	1/2	0.787	0.768	0.728	0.630	1.102	0.591
ND6500 08-12*	1/2	3/4	0.787	0.768	0.827	0.630	1.102	0.945
ND6500 10-06	5/8	3/8	0.976	0.984	0.689	0.492	1.378	0.787
ND6500 10-08	5/8	1/2	0.976	0.984	0.748	0.610	1.378	0.787
ND6500 12-06*	3/4	3/8	1.094	1.122	0.768	0.492	1.437	0.945
ND6500 12-08	3/4	1/2	1.094	1.122	0.827	0.630	1.437	0.945
ND6500 12-12	3/4	3/4	1.094	1.122	0.827	0.630	1.437	0.945

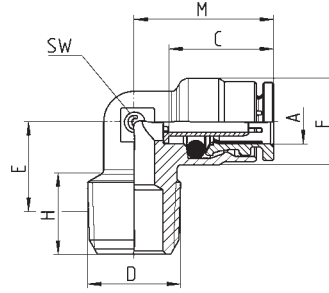

\*Produced Upon Request  
Contact Camozzi USA for Availability



**Fittings Model ND6523**

Female Swivel Elbow

**DIMENSIONS (in inches)**

Mod.	A OD	D NPTF	C	F	H	L	M	SW	SW1
ND6523 53-02	5/32	1/8	0.520	0.354	0.276	0.787	0.689	0.315	0.512
ND6523 53-04	5/32	1/4	0.520	0.354	0.394	0.945	0.689	0.315	0.669
ND6523 04-02	1/4	1/8	0.606	0.500	0.276	0.827	0.807	0.354	0.512
ND6523 04-04	1/4	1/4	0.606	0.500	0.394	0.984	0.807	0.354	0.669
ND6523 04-06	1/4	3/8	0.606	0.500	0.413	0.984	0.807	0.354	0.787
ND6523 06-02*	3/8	1/8	0.787	0.650	0.276	0.945	1.043	0.512	0.551
ND6523 06-04	3/8	1/4	0.787	0.650	0.394	1.102	1.043	0.512	0.669
ND6523 06-06	3/8	3/8	0.787	0.650	0.413	1.122	1.043	0.512	0.787
ND6523 06-08*	3/8	1/2	0.787	0.650	0.551	1.299	1.043	0.512	0.945
ND6523 08-04	1/2	1/4	0.787	0.650	0.394	1.122	1.102	0.591	0.669
ND6523 08-06	1/2	3/8	0.787	0.768	0.413	1.181	1.102	0.591	0.787
ND6523 08-08	1/2	1/2	0.787	0.768	0.551	1.339	1.102	0.591	0.945
ND6523 10-08	5/8	1/2	0.976	0.984	0.551	1.555	1.378	0.787	0.945

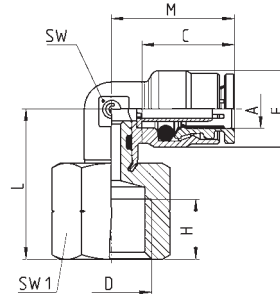

\*Produced Upon Request  
Contact Camozzi USA for Availability



**Fittings Model ND6110**

Male Swivel 45° Connector

**DIMENSIONS (in inches)**

Mod.	A OD	D NPTF	C	F	E	H	L	M	SW	SW1
ND6110 04-02	1/4	1/8	0.606	0.500	0.630	0.315	1.555	0.827	0.433	0.472
ND6110 04-04	1/4	1/4	0.606	0.500	0.669	0.472	1.713	0.827	0.433	0.551
ND6110 04-06	1/4	3/8	0.606	0.500	0.650	0.472	1.732	0.827	0.433	0.748
ND6110 06-04	3/8	1/4	0.787	0.650	0.709	0.472	1.969	1.063	0.591	0.669
ND6110 06-06	3/8	3/8	0.787	0.650	0.669	0.472	1.969	1.063	0.591	0.748
ND6110 06-08	3/8	1/2	0.787	0.650	0.748	0.610	2.126	1.063	0.591	0.866
ND6110 08-06	1/2	3/8	0.787	0.768	0.669	0.472	2.028	1.102	0.591	0.748
ND6110 08-08	1/2	1/2	0.787	0.768	0.748	0.610	2.185	1.102	0.591	0.866
ND6110 10-08	5/8	1/2	0.976	0.984	0.945	0.610	2.638	1.398	0.906	0.945
ND6110 12-12	3/4	3/4	1.094	1.122	0.945	0.610	2.717	1.437	0.906	1.063

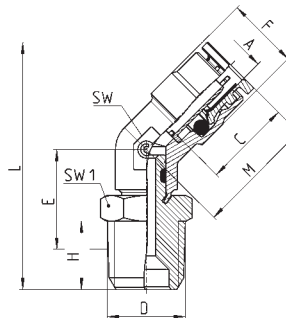



Fittings Model ND6430

Male Swivel Branch Tee

DIMENSIONS (in inches)

Mod.	A OD	D NPTF	C	F	E	H	L	M	N	SW	SW1
ND6430 53-02	5/32	1/8	0.520	0.354	0.650	0.315	1.378	0.689	0.827	0.315	0.472
ND6430 53-04	5/32	1/4	0.520	0.354	0.689	0.472	1.378	0.689	0.984	0.315	0.551
ND6430 04-02	1/4	1/8	0.606	0.500	0.669	0.315	1.614	0.807	0.846	0.354	0.472
ND6430 04-04	1/4	1/4	0.606	0.500	0.709	0.472	1.614	0.807	1.004	0.354	0.551
ND6430 04-06	1/4	3/8	0.606	0.500	0.689	0.472	1.614	0.807	1.024	0.354	0.748
ND6430 06-02	3/8	1/8	0.787	0.650	0.787	0.315	2.087	1.043	0.965	0.512	0.472
ND6430 06-04	3/8	1/4	0.787	0.650	0.827	0.472	2.087	1.043	1.122	0.512	0.551
ND6430 06-06	3/8	3/8	0.787	0.650	0.807	0.472	2.087	1.043	1.142	0.512	0.748
ND6430 06-08	3/8	1/2	0.787	0.650	0.886	0.610	2.087	1.043	1.299	0.512	0.866
ND6430 08-04	1/2	1/4	0.787	0.768	0.886	0.472	2.205	1.102	1.181	0.591	0.669
ND6430 08-06	1/2	3/8	0.787	0.768	0.846	0.472	2.205	1.102	1.181	0.591	0.748
ND6430 08-08	1/2	1/2	0.787	0.768	0.925	0.610	2.205	1.102	1.339	0.591	0.866
ND6430 10-06*	5/8	3/8	0.976	0.984	0.984	0.472	2.756	1.378	1.535	0.787	0.866
ND6430 10-08	5/8	1/2	0.976	0.984	1.122	0.610	2.756	1.378	1.535	0.787	0.866

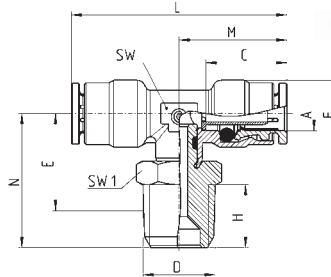

\*Produced Upon Request  
Contact Camozzi USA for Availability

Fittings Model ND6440

Male Swivel Run Tee

DIMENSIONS (in inches)

Mod.	A OD	D NPTF	C	F	E	H	L	M	SW	SW1
ND6440 53-02	5/32	1/8	0.520	0.354	0.650	0.315	1.516	0.689	0.315	0.472
ND6440 53-04	5/32	1/4	0.520	0.354	0.689	0.472	1.673	0.689	0.315	0.551
ND6440 04-02	1/4	1/8	0.606	0.500	0.669	0.315	1.654	0.807	0.354	0.472
ND6440 04-04	1/4	1/4	0.606	0.500	0.709	0.472	1.811	0.807	0.354	0.551
ND6440 04-06	1/4	3/8	0.606	0.500	0.689	0.472	1.831	0.807	0.354	0.748
ND6440 04-08*	1/4	1/2	0.606	0.500	0.826	0.472	1.988	0.807	0.354	0.866
ND6440 06-04	3/8	1/4	0.787	0.650	0.827	0.472	2.165	1.043	0.512	0.551
ND6440 06-06	3/8	3/8	0.787	0.650	0.807	0.472	2.185	1.043	0.512	0.748
ND6440 06-08	3/8	1/2	0.787	0.650	0.886	0.610	2.343	1.043	0.512	0.866
ND6440 08-04	1/2	1/4	0.787	0.768	0.886	0.472	2.283	1.102	0.591	0.669
ND6440 08-06	1/2	3/8	0.787	0.768	0.846	0.472	2.283	1.102	0.591	0.748
ND6440 08-08	1/2	1/2	0.787	0.768	0.925	0.610	2.441	1.102	0.591	0.866
ND6440 10-08	5/8	1/2	0.976	0.984	1.122	0.610	2.913	1.378	0.787	0.866

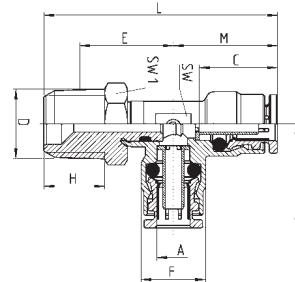

\*Produced Upon Request  
Contact Camozzi USA for Availability

Fittings Model ND6450

Male Swivel "Y"

DIMENSIONS (in inches)

Mod.	A OD	D NPTF	C	F	H	L	M	SW1
ND6450 53-02	5/32	1/8	0.520	0.709	0.315	1.358	0.354	0.472
ND6450 04-02	1/4	1/8	0.606	0.965	0.315	1.496	0.492	0.472
ND6450 04-04	1/4	1/4	0.606	0.965	0.472	1.535	0.492	0.551
ND6450 06-04	3/8	1/4	0.787	1.260	0.472	2.067	0.630	0.669
ND6450 08-06	1/2	3/8	0.787	1.575	0.472	2.106	0.748	0.748
ND6450 08-08	1/2	1/2	0.787	1.575	0.610	2.185	0.748	0.866

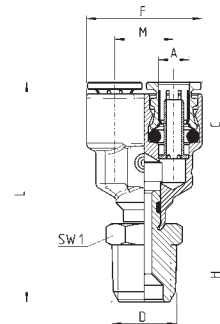

**Fittings Model ND6580**

Union

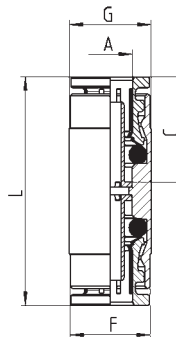

DIMENSIONS (in inches)					
Part No.	A OD	C	F	G	L
ND6580 53-00	5/32	0.520	0.331	0.354	1.142
ND6580 04-00	1/4	0.606	0.461	0.472	1.319
ND6580 06-00	3/8	0.787	0.606	0.650	1.673
ND6580 08-00	1/2	0.787	0.736	0.768	1.673
ND6580 10-00	5/8	0.976	0.925	0.976	2.047
ND6580 12-00	3/4	1.094	1.055	1.094	2.047

**Fittings Model ND6580**

Reducing Union

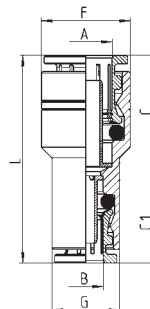

DIMENSIONS (in inches)							
Part No.	A OD	B	C	C1	F	G	L
ND6580 04-53	1/4	5/32	0.606	0.520	0.472	0.362	1.240
ND6580 06-04	3/8	1/4	0.787	0.606	0.650	0.492	1.516

**Fittings Model ND6590**

Bulkhead Union

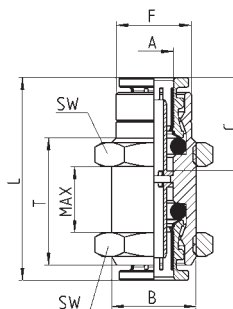

DIMENSIONS (in inches)								
Part No.	A OD	B	C	F	MAX	L	T	SW
ND6590 53-00	5/32	M10X1	0.520	0.346	0.472	1.142	0.787	0.551
ND6590 04-00	1/4	M14X1	0.606	0.492	0.512	1.319	0.827	0.669
ND6590 06-00	3/8	M18X1	0.787	0.650	0.591	1.673	0.945	0.866
ND6590 08-00	1/2	M22X1	0.787	0.768	0.630	1.673	1.063	1.063
ND6590 10-00	5/8	M26X1	0.976	0.965	0.827	2.047	1.260	1.260

FITTINGS DOT

Fittings Model ND6463

Female Connector

**DIMENSIONS (in inches)**

Part No.	A OD	D NPTF	C	F	G	H	L	SW
ND6463 53-02	5/32	1/8	0.520	0.354	0.512	0.276	0.945	0.472
ND6463 53-04	5/32	1/4	0.520	0.354	0.650	0.394	1.102	0.591
ND6463 04-02	1/4	1/8	0.606	0.461	0.512	0.276	1.024	0.472
ND6463 04-04	1/4	1/4	0.606	0.469	0.650	0.394	1.181	0.591
ND6463 04-06*	1/4	3/8	0.606	0.461	0.787	0.413	1.220	0.472
ND6463 06-02	3/8	1/8	0.787	0.606	0.728	0.276	1.201	0.669
ND6463 06-04	3/8	1/4	0.787	0.606	0.728	0.394	1.339	0.669
ND6463 06-06	3/8	3/8	0.787	0.606	0.787	0.413	1.378	0.669
ND6463 06-08*	3/8	1/2	0.787	0.606	0.945	0.551	1.535	0.669
ND6463 06-12*	3/8	3/4	0.787	0.606	1.181	0.551	1.535	0.669
ND6463 08-02*	1/2	1/8	0.787	0.736	0.098	0.276	1.201	0.748
ND6463 08-04	1/2	1/4	0.787	0.736	0.807	0.394	1.339	0.748
ND6463 08-06	1/2	3/8	0.787	0.736	0.807	0.413	1.378	0.748
ND6463 08-08	1/2	1/2	0.787	0.736	0.945	0.551	1.516	0.748
ND6463 08-12*	1/2	3/4	0.787	0.736	1.181	0.551	1.535	0.748
ND6463 10-06*	5/8	3/8	0.976	0.965	0.965	0.413	1.575	0.866
ND6463 10-08	5/8	1/2	0.976	0.925	1.043	0.551	1.732	0.945

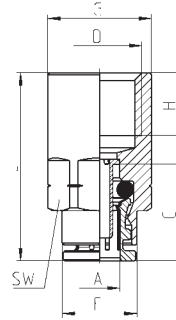

\*Produced Upon Request  
Contact Camozzi USA for Availability



Fittings Model ND6550

Union Elbow

**DIMENSIONS (in inches)**

Part No.	A OD	C	F	M	SW
ND6550 53-00	5/32	0.520	0.354	0.689	0.315
ND6550 04-00	1/4	0.606	0.500	0.807	0.354
ND6550 06-00	3/8	0.787	0.650	1.043	0.512
ND6550 08-00	1/2	0.787	0.768	1.102	0.591
ND6550 10-00	5/8	0.976	0.984	1.378	0.787

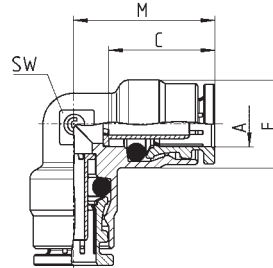

Fittings Model ND6750

Tube Cap

**DIMENSIONS (in inches)**

Mod.	A OD	C	F	L
ND6750 53-00	5/32	0.520	0.346	0.591
ND6750 04-00	1/4	0.606	0.472	0.610

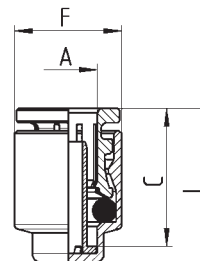

Fittings Model ND6560

Union "Y"

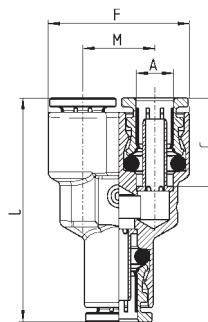

DIMENSIONS (in inches)					
Part No.	A OD	C	F	L	M
ND6560 53-00	5/32	0.520	0.709	1.299	0.354
ND6560 04-00	1/4	0.606	0.965	1.535	0.492
ND6560 06-00	3/8	0.787	1.260	2.146	0.630
ND6560 08-00	1/2	0.787	1.575	2.244	0.748

Fittings Model ND6540

Union Tee

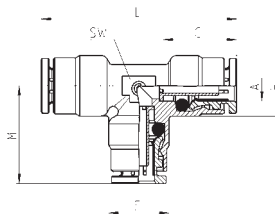

DIMENSIONS (in inches)						
Mod.	A OD	C	F	M	L	SW
ND6540 53-00	5/32	0.520	0.354	0.689	1.378	0.315
ND6540 04-00	1/4	0.606	0.500	0.807	1.614	0.354
ND6540 06-00	3/8	0.787	0.650	1.043	2.086	0.512
ND6540 08-00	1/2	0.787	0.768	1.122	2.204	0.591
ND6540 10-00	5/8	0.976	0.984	1.378	2.756	0.787
ND6540 12-00	3/4	1.094	1.122	1.437	2.874	0.945

Fittings Model ND6540

Reducing Union Tee

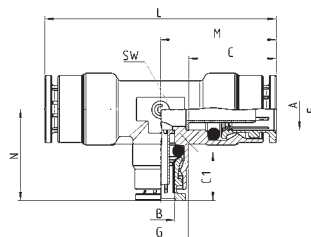

DIMENSIONS (in inches)										
Mod.	A OD	B OD	C	C1	F	G	M	N	L	SW
ND6540 06-06-04	3/8	1/4	0.787	0.606	0.650	0.500	1.043	0.827	2.087	0.512
ND6540 08-08-04*	1/2	1/4	0.787	0.606	0.768	0.500	1.102	0.886	2.205	0.591
ND6540 08-08-06*	1/2	3/8	0.787	0.787	0.768	0.650	1.102	1.102	2.205	0.591

\*Produced Upon Request  
Contact Camozzi USA for Availability

**Fittings Mod. ND6560**

Unequal Union "Y"

All Models are Produced Upon Request  
Contact Camozzi USA for Availability

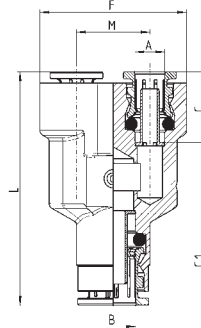

**DIMENSIONS (in inches)**

Part No.	A OD	B	C	C1	F	L	M
ND6560 04-06	1/4	3/8	0.606	0.787	1.260	2.008	0.630
ND6560 06-08	3/8	1/2	0.787	0.787	1.575	2.244	0.748

**Fittings Model ND6700**

Cartridge



**Dimensions**

Mod.	Cartridge					Cavity				Installation Tool				
	A OD	C	G	M	L	S (±0.002)	K (min)	H (min)	R	D	E	N	O	P Max (lbs.)
ND6700 53-00	5/32	0.520	0.394	0.413	0.571	0.346	0.059	0.449	0.020	0.346	0.406	0.071	0.150	926
ND6700 04-00	1/4	0.606	0.551	0.480	0.657	0.504	0.079	0.500	0.020	0.465	0.563	0.071	0.169	1102
ND6700 06-00	3/8	0.787	0.701	0.638	0.835	0.650	0.079	0.650	0.020	0.622	0.713	0.071	0.189	2028
ND6700 08-00	1/2	0.787	0.827	0.638	0.835	0.776	0.079	0.780	0.020	0.713	0.839	0.071	0.189	2094

- \* Cavity dimensions listed above are suitable for non-metallic cavities, however based on the SAE J2494-4 Cartridge Cavity Dimensional Specification, cavities made from materials other than T6061-T6 aluminum may need to be adjusted dimensionally so that when installed; the tube/cartridge/cavity assembly will pass the applicable performance tests in SAE J1131 and SAE J2494-3.
- \* The dimension for the installation tool should be noted and followed as a properly machined tool creates a specific mechanical stop which serves the purpose of avoiding damage to the collet body due to excessive insertion force being used.
- \* Surface Finish of the gland seat required: Ra <math>\leq 3.2</math> microns.
- \* INSTALLATION: Drill or bore hole per specifications per size of cartridge (dimensions H, S, and K).
- \* Simply press fit cartridge into hole with an evenly distributed force over the top surface.
- \* Removal of the collet ring is not necessary.
- \* Cartridge fittings are useful for installations in various manifolds and/or distribution blocks when drilling and tapping are not desirable.
- \* For cavity specification requirements see SAE J2494-4

**Fittings Model ND6593**

Female Bulkhead

All Models are Produced Upon Request  
Contact Camozzi USA for Availability

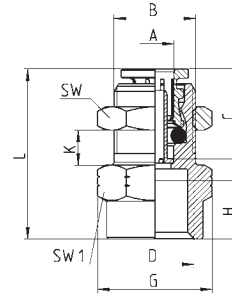

DIMENSIONS (in inches)											
Mod.	A OD	D NPTF	B	C	G	H	K (MAX)	K (MIN)	L	SW	SW1
ND6593 53-04	5/32	1/4	M10X1	0.520	0.776	0.394	0.335	0.079	1.122	0.551	0.669
ND6593 04-02	1/4	1/8	M14X1	0.606	0.776	0.276	0.394	0.079	1.024	0.669	0.669
ND6593 04-04	1/4	1/4	M14X1	0.606	0.776	0.394	0.394	0.079	1.142	0.669	0.669
ND6593 06-04	3/8	1/4	M18X1	0.787	1.005	0.394	0.531	0.079	1.339	0.866	0.866
ND6593 06-06	3/8	3/8	M18X1	0.787	1.005	0.413	0.531	0.079	1.358	0.866	0.866
ND6593 06-08	3/8	1/2	M18X1	0.787	1.096	0.551	0.531	0.079	1.496	0.866	0.945
ND6593 08-06	1/2	3/8	M22X1	0.787	1.096	0.413	0.492	0.079	1.358	1.063	0.945
ND6593 08-08	1/2	1/2	M22X1	0.787	1.096	0.551	0.492	0.079	1.496	1.063	0.945

**Fittings Model ND6503**

Female Non-Swivel Elbow

All Models are Produced Upon Request  
Contact Camozzi USA for Availability

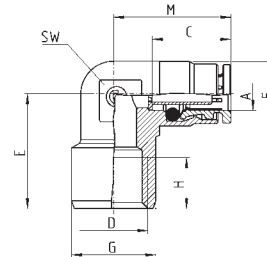

DIMENSIONS (in inches)									
Mod.	A OD	D NPTF	C	E	F	G	H	M	SW
ND6503 04-02	1/4	1/8	0.606	0.709	0.500	0.512	0.276	0.807	0.354
ND6503 04-04	1/4	1/4	0.606	0.886	0.500	0.650	0.394	0.906	0.512
ND6503 04-06	1/4	3/8	0.606	1.102	0.587	0.787	0.413	0.906	0.591
ND6503 06-02	3/8	1/8	0.787	0.748	0.650	0.512	0.276	1.043	0.512
ND6503 06-04	3/8	1/4	0.787	0.886	0.650	0.650	0.394	1.043	0.512
ND6503 06-06	3/8	3/8	0.787	1.102	0.650	0.787	0.413	1.063	0.591
ND6503 08-04	1/2	1/4	0.787	0.945	0.768	0.650	0.394	1.102	0.591
ND6503 08-06	1/2	3/8	0.787	1.102	0.768	0.787	0.413	1.102	0.591
ND6503 08-08	1/2	1/2	0.787	1.260	0.768	0.945	0.551	1.142	0.787

**Fittings Model ND6100**

Male Non-Swivel 45° Connector

All Models are Produced Upon Request  
Contact Camozzi USA for Availability

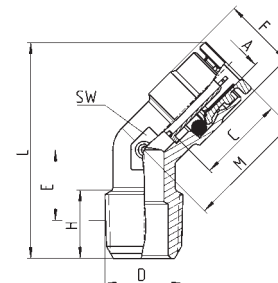

DIMENSIONS (in inches)									
Mod.	A OD	D NPTF	C	F	E	H	L	M	SW
ND6100 04-02	1/4	1/8	0.606	0.500	0.413	0.335	1.327	0.827	0.433
ND6100 04-04	1/4	1/4	0.606	0.500	0.453	0.472	1.484	0.827	0.433
ND6100 06-02	3/8	1/8	0.787	0.650	0.492	0.335	1.634	1.063	0.591
ND6100 06-04	3/8	1/4	0.787	0.650	0.512	0.492	1.772	1.063	0.591
ND6100 06-06	3/8	3/8	0.787	0.650	0.453	0.433	1.752	1.063	0.591
ND6100 06-08	3/8	1/2	0.787	0.650	0.531	0.591	1.909	1.063	0.591
ND6100 08-04	1/2	1/4	0.787	0.768	0.512	0.492	1.831	1.102	0.591
ND6100 08-06	1/2	3/8	0.787	0.768	0.453	0.433	1.811	1.102	0.591
ND6100 08-08	1/2	1/2	0.787	0.768	0.531	0.591	1.969	1.102	0.591
ND6100 10-06	5/8	3/8	0.976	0.984	0.630	0.492	2.248	1.398	0.906
ND6100 10-08	5/8	1/2	0.976	0.984	0.689	0.630	2.386	1.398	0.906
ND6100 12-08	3/4	1/2	1.094	1.122	0.689	0.630	2.469	1.437	0.906
ND6100 12-12	3/4	3/4	1.094	1.122	0.709	0.610	2.488	1.437	0.906

**Fittings Model ND6420**

Male Non-Swivel Run Tee

All Models are Produced Upon Request  
Contact Camozzi USA for Availability

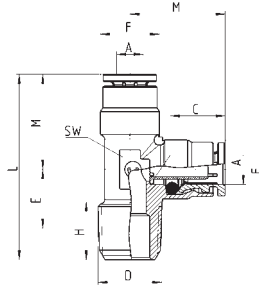

DIMENSIONS (in inches)									
Mod.	A OD	D NPTF	C	F	E	H	L	M	SW
ND6420 04-02	1/4	1/8	0.606	0.500	0.472	0.413	1.457	0.807	0.354
ND6420 04-04	1/4	1/4	0.606	0.500	0.472	0.492	1.575	0.807	0.433
ND6420 06-04	3/8	1/4	0.787	0.650	0.551	0.492	1.890	1.043	0.512
ND6420 06-06	3/8	3/8	0.787	0.650	0.571	0.492	1.969	1.063	0.591
ND6420 06-08	3/8	1/2	0.787	0.650	0.650	0.630	2.126	1.063	0.669
ND6420 08-04	1/2	1/4	0.787	0.768	0.610	0.492	2.008	1.102	0.591
ND6420 08-06	1/2	3/8	0.787	0.768	0.571	0.492	2.008	1.102	0.591

**Fittings Model ND6800**

Plug-In Reducer

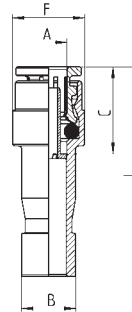

DIMENSIONS (in inches)					
Mod.	A OD	B STEM OD	C	F	L
ND6800 04-06	1/4	3/8	0.606	0.500	1.457

**Fittings Model ND6555**

Plug-In Elbow

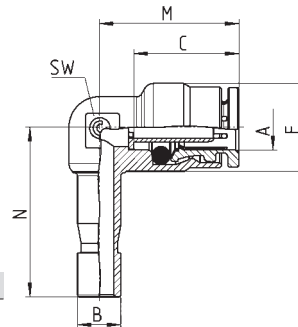

DIMENSIONS (in inches)							
Mod.	A OD	B STEM OD	C	F	M	N	SW
ND6555 04-04	1/4	1/4	0.606	0.500	0.807	0.965	0.354

**Fittings Model ND6433**

Female Swivel Branch Tee

All Models are Produced Upon Request  
Contact Camozzi USA for Availability

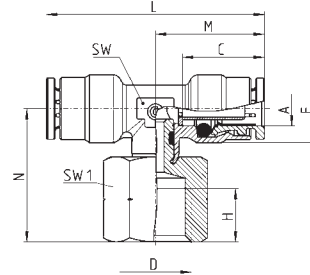

**DIMENSIONS (in inches)**

Mod.	A OD	D NPTF	C	F	H	L	M	N	SW	SW1
ND6433 04-04	1/4	1/4	0.606	0.500	0.394	1.614	0.807	0.827	0.354	0.669
ND6433 06-04	3/8	1/4	0.787	0.650	0.394	2.087	1.043	1.102	0.512	0.669
ND6433 06-06	3/8	3/8	0.787	0.650	0.413	2.087	1.043	1.122	0.512	0.787
ND6433 08-04	1/2	1/4	0.787	0.768	0.394	2.205	1.102	1.122	0.591	0.669
ND6433 08-06	1/2	3/8	0.787	0.768	0.413	2.205	1.102	1.181	0.591	0.787
ND6433 08-08	1/2	1/2	0.787	0.768	0.551	2.205	1.102	1.339	0.591	0.945

**Fittings Model ND6410**

Male Non-Swivel Branch Tee

All Models are Produced Upon Request  
Contact Camozzi USA for Availability

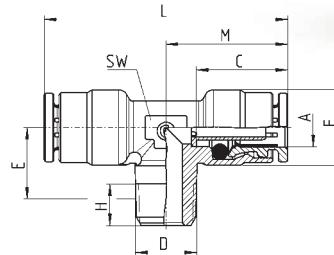

**DIMENSIONS (in inches)**

Mod.	A OD	D NPTF	C	F	E	H	L	M	SW
ND6410 04-02	1/4	1/8	0.606	0.500	0.472	0.413	1.614	0.807	0.354
ND6410 04-04	1/4	1/4	0.606	0.500	0.472	0.472	1.614	0.807	0.433
ND6410 04-06	1/4	3/8	0.606	0.512	0.610	0.472	1.614	0.807	0.512
ND6410 06-02	3/8	1/8	0.787	0.650	0.531	0.335	2.087	1.043	0.512
ND6410 06-04	3/8	1/4	0.787	0.650	0.551	0.492	2.087	1.043	0.512
ND6410 06-06	3/8	3/8	0.787	0.650	0.571	0.492	2.126	1.063	0.591
ND6410 06-08	3/8	1/2	0.787	0.650	0.650	0.630	2.283	1.142	0.669
ND6410 08-04	1/2	1/4	0.787	0.768	0.610	0.492	2.205	1.102	0.591
ND6410 08-06	1/2	3/8	0.787	0.768	0.571	0.492	2.205	1.102	0.591
ND6410 08-08	1/2	1/2	0.787	0.768	0.650	0.630	2.283	1.142	0.669

**Fittings Model ND6413**

Female Non-Swivel Branch Tee

All Models are Produced Upon Request  
Contact Camozzi USA for Availability

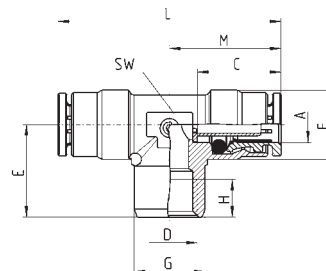

**DIMENSIONS (in inches)**

Mod.	A OD	D NPTF	C	E	F	G	H	L	M	SW
ND6413 04-02	1/4	1/8	0.606	0.669	0.500	0.512	0.276	1.614	0.807	0.433
ND6413 04-04	1/4	1/4	0.606	0.885	0.591	0.650	0.394	1.811	0.906	0.591
ND6413 06-04	3/8	1/4	0.787	0.885	0.650	0.650	0.394	2.126	1.063	0.591
ND6413 06-06	3/8	3/8	0.787	1.024	0.650	0.787	0.413	2.205	1.102	0.669



Fittings Model 6900...

Plug (Nylon®)

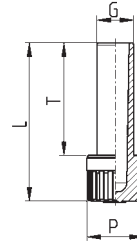

**DIMENSIONS (in inches)**

Model	G STEM OD	L	P	T
6900 04-00	1/4	1.240	.315	.885
6900 06-00	3/8	1.456	.472	1.063
6900 08-00	1/2	1.594	.630	1.122

Plastic tubes cutters Model PNZ

Small and Large Tube  
Cutter



Model	Replacement Blade
PNZ-12	able to cut tubes with Ø up to 12 mm (1/2") LAME X PNZ-12
PNZ-25	able to cut tubes with Ø up to 25 mm (1") LAME X PNZ-25

Plastic tubes cutter Model PNZP-12



Model	
PNZP-12	able to cut tubes with Ø till to 12 mm

Fitting Protection Cap Model 6708

Color : Black  
Self-extinguishing material, class V0

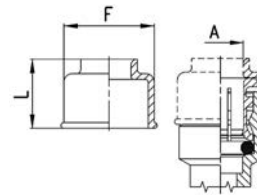

**DIMENSIONS (in mm)**

Model	A	F	L	Weight (g)
6708 4	5/32	10.7	10.7	1
6708 6	1/4	13.7	11.5	1
6708 10	3/8	18.5	13	1
6708 12	1/2	20.7	15	2

DOT Tubing Model TEA

Color : Black  
Meets SAE Specification J844, J1131, J2494-3 and DOT-FMVSS 106



**DIMENSIONS (in inches)**

Model	Outer Diameter	Inner Diameter	Minimum Burst Pressure (psi)	Weight (lb./100ft)	Bend radius (inches)	Length (feet)
TEA 53-BK-PA-1000FT	5/32	.092	1200	.56	1/2	1000
TEA 53-BK-PA-100FT	5/32	.092	1200	.56	1/2	100
TEA 04-BK-PA-1000FT	1/4	.170	1200	1.19	1	1000
TEA 04-BK-PA-100FT	1/4	.170	1200	1.19	1	100
TEA 06-BK-PA-500FT	3/8	.251	1400	2.8	1.5	500
TEA 06-BK-PA-100FT	3/8	.251	1400	2.8	1.5	100
TEA 08-BK-PA-500FT	1/2	.376	950	3.8	2	500
TEA 08-BK-PA-100FT	1/2	.376	950	3.8	2	100
TEA 10-BK-PA-250FT	5/8	.441	900	7	2.5	250
TEA 10-BK-PA-50FT	5/8	.441	900	7	2.5	50
TEA 12-BK-PA-250FT	3/4	.566	800	8.6	3	250
TEA 12-BK-PA-50FT	3/4	.566	800	8.6	3	50



FITTINGS DOT

*Camozzi  
in the world*

**Camozzi spa  
Società Unipersonale**

Via Eritrea, 20/1  
25126 Brescia  
**Italy**  
Tel. +39 030/37921  
Fax +39 030/2400430  
sales@camozzi.com  
www.camozzi.com

**Camozzi Neumatica S.A.**

Polo Industrial Ezeiza, Puente  
del Inca 2450, B1812IDX, Carlos  
Spegazzini, Ezeiza  
Buenos Aires - 1437  
**Argentina**  
Tel. +54 11/49110816  
Fax +54 11/49124191  
info@camozzi.com.ar  
www.camozzi.com.ar

**Camozzi GmbH Pneumatic**

Löfflerweg 18  
A-6060 Hall in Tirol  
**Austria**  
Tel. +43 5223/52888-0  
Fax +43 5223/52888-500  
info@camozzi.at  
www.camozzi.at

**Camozzi do Brasil Ltda.**

Rua Estácio de Sá, 1042  
13080-010 Campinas SP  
**Brazil**  
Tel. +55 19/21374500  
Fax +55 19/21374530  
sac@camozzi.com.br  
www.camozzi.com.br

**Camozzi Pneumatic**

66-1, Perehodnaya str.,  
220070, Minsk  
**Belarus**  
Tel. +375 17/3961170 (71)  
Fax +375 17/3961170 (71)  
info@camozzi.by  
www.camozzi.by

**Shanghai Camozzi Automation  
Control Co, Ltd.**

717 Shuang Dan Road, Malu  
Shanghai - 201801  
**China**  
Tel. +86 21/59100999  
Fax +86 21/59100333  
info@camozzi.com.cn  
www.camozzi.com.cn

**Camozzi S.r.o.**

V Chotejně 700/7  
Praha - 10200  
**Czech Republic**  
Tel. +420 272/690 994  
Fax +420 272/700 485  
info@camozzi.cz  
www.camozzi.cz

**Camozzi ApS**

Metalvej 7 F  
4000 Roskilde  
**Denmark**  
Tel. +45 46/750202  
info@camozzi.dk  
www.camozzi.dk

**Camozzi Automation OÜ**

Osmussaare 8-B204  
13811 Tallinn  
**Estonia**  
Tel. +372 6119055  
Fax +372 6119055  
info@camozzi.ee  
www.camozzi.ee

**Camozzi Pneumatique Sarl**

5, Rue Louis Gattefossé  
Parc de la Bandonnière  
69800 Saint-Priest  
**France**  
Tel. +33 (0)478/213408  
Fax +33 (0)472/280136  
info@camozzi.fr  
www.camozzi.fr

**Camozzi GmbH Pneumatic**

Porschestraße 1  
D-73095 Albershausen  
**Germany**  
Tel. +49 7161/91010-0  
Fax +49 7161/91010-99  
info@camozzi.de  
www.camozzi.de

**Camozzi India Private Limited**

No D-44 Phase II Ext.,  
Hosiery Complex  
Noida - 201 305  
Uttar Pradesh  
**India**  
Tel. +91 120/4055252  
Fax +91 120/4055200  
info@camozzi-india.com  
www.camozzi.in

**Camozzi Pneumatic**

**Kazakhstan LLP**  
Shevchenko/Radostovets,  
165b/72g, off. 615  
050009 Almaty  
**Kazakhstan**  
Tel. +7 727/3335334 - 3236250  
Fax +7 727/2377716 (17)  
info@camozzi.kz  
www.camozzi.kz

**Camozzi Malaysia SDN. BHD.**

30 & 32, Jalan Industri USJ 1/3  
Taman Perindustrian USJ 1  
47600 Subang Jaya  
Selangor  
**Malaysia**  
Tel. +60 3/80238400  
Fax +60 3/80235626  
cammal@camozzi.com.my  
www.camozzi.com.my

**Camozzi Neumatica de Mexico**

**S.A. de C.V.**  
Lago Tanganica 707  
Col. Ocho Cedros 2ª sección  
50170 Toluca  
**México**  
Tel. +52 722/2707880 - 2126283  
Fax +52 722/2707860  
camozzi@camozzi.com.mx  
www.camozzi.com.mx

**Camozzi AS**

Verstedveien 8  
1400 Ski  
**Norway**  
Tel. +47 40644920  
info@camozzi.no  
www.camozzi.no

**Camozzi Pneumatic LLC**

141597 Moscow Oblast  
Chashnikovo,  
Solnechnogorsk, Russia  
**Russian Federation**  
Tel. +7 495/7866585  
Fax +7 495/7279191  
info@camozzi.ru

www.camozzi.ru

**Camozzi Pneumatik AB**

Box 9214  
Bronsyxegatan 7  
20039 Malmö  
**Sweden**  
Tel. +46 40/6005800  
info@camozzi.se  
www.camozzi.se

**Camozzi Benelux B.V.**

De Vijf Boeken 1 A  
2911 BL Nieuwerkerk a/d IJssel  
**The Netherlands**  
Tel. +31 180/316677  
Fax +31 180/316616  
info@camozzi.nl  
www.camozzi.nl

**LLC Camozzi**

Kirilovskaya Str, 1-3, section "D"  
Kiev - 04080  
**Ukraine**  
Tel. +38 044/5369520  
Fax +38 044/5369520  
info@camozzi.ua  
www.camozzi.ua

**Camozzi Pneumatics Ltd.**

The Fluid Power Centre  
Watling Street  
Nuneaton, Warwickshire  
CV11 6BQ  
**United Kingdom**  
Tel. +44 (0)24/76374114  
Fax +44 (0)24/76347520  
info@camozzi.co.uk  
www.camozzi.co.uk

**Camozzi Pneumatics Inc.**

Street address:  
2160 Redbud Boulevard, Suite 101  
McKinney, TX 75069-8252  
Remittances:  
P.O. Box 678518  
Dallas, TX 75267-8518  
**USA**  
Tel. +1 972/5488885  
Fax +1 972/5482110  
info@camozzi-usa.com  
www.camozzi-usa.com

**Camozzi Venezuela S.A.**

Calle 146 con Av. 62  
N°146-180  
P.O. Box 529  
Zona Industrial Maracaibo  
Edo. Zulia  
**Venezuela**  
Tel. +58 261/7360821  
Fax +58 261/7360401  
info@camozzi.com.ve  
www.camozzi.com.ve

**Camozzi R.O.**

**in Hochiminh City**  
6<sup>th</sup> Floor, Master Building,  
155 Hai Ba Trung St.,  
Ward 6, District 3  
Hochiminh City  
**Vietnam**  
Tel. +84 8/54477588  
Fax +84 8/54477877  
bhthien@camozzi.com.vn  
www.camozzi.com.vn

## Contact

**Camozzi Automation, Inc.**  
2160 Redbud Blvd ., Suite 101  
Mckinney, Texas 75069-8252  
Tel 972 548 8885  
sales@camozzi-usa.com



Automation