



# Kuriyama Industrial Sheet Rubber

## SHEET RUBBER, MATTING & SPECIALTY ITEMS CATALOG



**Kuriyama of America, Inc.**



**EDITION 0320**



## Index

48" Wide Economy Skirtboard Slab Rubber .....	17	Neoprene Cloth-Inserted Sheet .....	5
60 Durometer Skirtboard .....	17	Neoprene Diaphragm Sheet.....	5
80 Durometer Skirtboard .....	18	Neoprene Sheet.....	3-4
Black Cloth-Inserted SBR Sheet .....	8	Neoprene Slab Rubber .....	4
Black SBR Sheet.....	8	Nitrile Sheet .....	6
Black "V" Corrugated Rubber Matting .....	15	Premium Tan Pure Gum Sheet .....	13
Black Wide-Ribbed Premium Rubber Matting.....	15	Red Pure Gum Sheet.....	12
Channel Rubber Strip.....	16	Red SBR Sheet Plate and Fabric Finish.....	9
Cautionary Statement & Limited Warranty.....	Back Cover	Sheet Rubber Glossary.....	21-22
CSM Sheet .....	10	Shelf Life and Storage Information .....	24
EPDM Sheet.....	11	Special Economy Skirtboard .....	19-20
FDA Silicone Sheet .....	12	Tan Pure Gum Sheet .....	14
FDA White Nitrile Sheet.....	7	Viton® Sheet.....	10
General Properties/Tolerances .....	23		

## Index By Series Number

Series	Page
B60	6
B70	6
BL60	8
CI	8
E60	11
E80	11
ESK60	17
ESK80	18
EZMAT	15
GF40	13
GF490	14
HFTCHNL	16
HY60	10
MAT	15
N40	3
N50	3

Series	Page
N60	3-4
N70	4
N80	4
NCI	5
NDIA	5
R75	9
RF75	9
RG45	12
RTCHNL	16
SESK60	19-20
SILFG	12
SK60	17
THCHNL	16
VI70	10
W60	7

### Minimum Order: Full rolls only.

Sheet rubber and corrugated matting products are sold in full rolls only. These rolls are usually in one piece, but may contain a maximum of two pieces per ASTM D1330. The average weight per roll and linear feet per roll yield figures

shown in this catalog are conservative minimums. Actual yield may vary upwards. All rolls are billed at the listed average linear ft./roll shown in our separate price list.



Telephone KOA for widths and lengths not shown.





## General Properties of Neoprene†

- Good weather-resistance
- Moderate resistance to petroleum-based fluids
- Good physical properties.

† Properties shown based on Rubber Manufacturers Association Sheet Rubber Handbook, second edition.



## SPECIFICATIONS:

**Commercial grade black neoprene sheet, available in five styles:**

**Style N40:** 40 Duro hardness (Shore Durometer A)

**Style N50:** 50 Duro hardness (Shore Durometer A)

**Style N60:** 60 Duro hardness (Shore Durometer A)

**Style N70:** 70 Duro hardness (Shore Durometer A)

**Style N80:** 80 Duro hardness (Shore Durometer A)

**Polymer:** Chloroprene

**Common Name:** Neoprene

**ISO/ASTM Designation:** CR

**Talc Free**

Style	ASTM Specification (SI units)	Temp. Range	Durometer	Tensile Strength (psi)	Elongation (%)	Finish
N40	D 2000 M2BC 407 A14 B14 F17	-20°F to +180°F	35 - 45	1015	400%	Plate
N50	D 2000 M2BC 507 A14 B14 F17	-20°F to +180°F	45 - 55	1015	300%	Plate
N60	D 2000 M2BC 607 A14 B14 F17	-20°F to +180°F	55 - 65	1015	300%	Plate
N70	D 2000 M2BC 707 A14 B14 F17	-20°F to +180°F	65 - 75	1015	200%	Plate
N80	D 2000 M2BC 807 A14 B14 F17	-20°F to +180°F	75 - 85	1015	100%	Plate

## ORDERING INFORMATION:

Part Number	Gauge x Width (in)	Avg. Length (Linear ft/Roll)	Approx. lbs/Roll
N40-02x36x67	1/16 x 36	67	96
N40-04x36x67	1/8 x 36	67	195
N40-06x36x36	3/16 x 36	36	158
N40-08x36x36	1/4 x 36	36	210
N40-02x48x67	1/16 x 48	67	128
N40-03x48x67	3/32 x 48	67	200
N40-04x48x67	1/8 x 48	67	256
N40-06x48x36	3/16 x 48	36	215
N40-08x48x36	1/4 x 48	36	280
N50-02x48x67	1/16 x 48	67	132
N50-04x48x36	1/8 x 48	36	142
N50-06x48x36	3/16 x 48	36	213
N50-08x48x18	1/4 x 48	18	142
N60-01x36x67	1/32 x 36	67	52
N60-02x36x67	1/16 x 36	67	99
N60-02x36x100	1/16 x 36	100	147
N60-02x72x67	1/16 x 72	67	197
N60-03x36x67	3/32 x 36	67	149
N60-04x36x50	1/8 x 36	50	148
N60-04x36x67	1/8 x 36	67	198
N60-04x36x100	1/8 x 36	100	295
N60-04x72x36	1/8 x 72	36	216
N60-06x36x36	3/16 x 36	36	161
N60-06x36x40	3/16 x 36	40	179
N60-06x36x50	3/16 x 36	50	223
N60-08x36x36	1/4 x 36	36	214
N60-08x36x40	1/4 x 36	40	238
N60-08x36x50	1/4 x 36	50	266
N60-12x36x18	3/8 x 36	18	160
N60-16x36x18	1/2 x 36	18	214
N60-16x36x25	1/2 x 36	25	297





**NEW ITEMS**

## NEOPRENE SHEET

### Neoprene (continued)

Part Number	Gauge x Width (in)	Avg. Length (Linear ft/Roll)	Approx. lbs/Roll
N60-24x36x25	3/4 x 36	25	443
N60-32x36x25	1 x 36	25	592
N60-02x48x67	1/16 x 48	67	132
N60-02x48x100	1/16 x 48	100	197
N60-03x48x67	3/32 x 48	67	200
N60-04x48x36	1/8 x 48	36	142
N60-04x48x50	1/8 x 48	50	197
N60-04x48x100	1/8 x 48	100	394
N60-06x48x36	3/16 x 48	36	213
N60-06x48x40	3/16 x 48	40	236
N60-06x48x50	3/16 x 48	50	296
N60-08x48x18	1/4 x 48	18	142
N60-08x48x40	1/4 x 48	40	316
N60-08x48x50	1/4 x 48	50	354
N60-08x72x25	1/4 x 72	25	300
N60-12x48x18	3/8 x 48	18	213
N60-12x48x30	3/8 x 48	30	355
N60-16x48x25	1/2 x 48	25	354
N60-16x48x30	1/2 x 48	30	471
N60-16x48x40	1/2 x 48	40	628
N60-24x48x25	3/4 x 48	25	590
N60-32x48x25	1 x 48	25	788
N70-02x48x67	1/16 x 48	67	132
N70-04x48x36	1/8 x 48	36	142
N70-06x48x36	3/16 x 48	36	213
N70-08x48x18	1/4 x 48	18	142
N80-02x36x50	1/16 x 36	50	74
N80-04x36x50	1/8 x 36	50	148
N80-06x36x50	3/16 x 36	50	223
N80-08x36x50	1/4 x 36	50	297

**NOTE:** N80 is also available in 48" width . . . contact Kuriyama of America.

**NEW ITEMS**

## NEOPRENE SLAB RUBBER

Style	ASTM Specification (SI units)	Temp. Range	Durometer	Tensile Strength (psi)	Elongation (%)	Finish
N60	D 2000 M2BC 603	-20°F to +180°F	55-65	400	150%	Plate

Part Number	Gauge x Width (in)	Avg. Length (Linear ft/Pd)	Approx. lbs/Slab
N60-48x48x10	1 1/2 x 48	10	445
N60-64x48x10	2 x 48	10	596





## General Properties of Neoprene†

- Excellent physical properties.

† Properties shown based on Rubber Manufacturers Association Sheet Rubber Handbook, second edition.

## SPECIFICATIONS:

**Commercial grade black neoprene sheet, with nylon reinforcement:**

**Style NCI:** 60 Duro hardness (Shore Durometer A)

**Polymer:** Chloroprene reinforced with 3.4 oz./sq. yd. nylon fabric

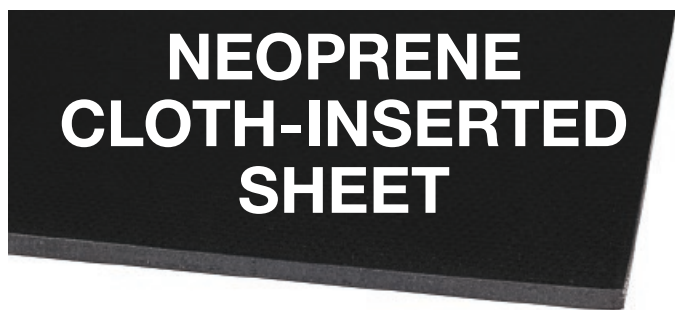

**Common Name:** Nylon-reinforced Neoprene Sheet

**ISO/ASTM Designation:** CR

**Talc Free**

Style	ASTM Specification (SI units)	Temp. Range	Ply	Durometer	Tensile Strength (psi)	Finish
NCI	D 2000 M2BC 607 A14 B14 F17	-20°F to +180°F	1	55 – 65	1100	Plate
NCI	D 2000 M2BC 607 A14 B14 F17	-20°F to +180°F	2	55 – 65	1100	Plate

## ORDERING INFORMATION:

Part Number	Gauge x Width (in)	Fabric Plies	Avg. Length (Linear ft/Roll)	Approx. lbs/Roll
NCI-1P02x36x67	1/16 x 36	1 Ply	67	93
NCI-1P02x36x100	1/16 x 36	1 Ply	100	138
NCI-2P04x36x36	1/8 x 36	2 Ply	36	98
NCI-2P04x36x50	1/8 x 36	2 Ply	50	141
NCI-2P06x36x36	3/16 x 36	2 Ply	36	146
NCI-2P08x36x36	1/4 x 36	2 Ply	36	196
NCI-2P08x36x50	1/4 x 36	2 Ply	50	273
NCI-2P04x48x50	1/8 x 48	2 Ply	50	181
NCI-2P08x48x50	1/4 x 48	2 Ply	50	364

## General Properties of Neoprene†

- Excellent physical properties.

† Properties shown based on Rubber Manufacturers Association Sheet Rubber Handbook, second edition.

## SPECIFICATIONS:

**Commercial grade black neoprene sheet, with nylon reinforcement:**

**Style NDIA:** 60 Duro hardness (Shore Durometer A)

**Polymer:** Chloroprene reinforced with 14.5 oz./sq. yd. nylon fabric



**Common Name:** Nylon-reinforced Neoprene Sheet

**ISO/ASTM Designation:** CR

**Talc Free**

Style	ASTM Specification (SI units)	Temp. Range	Ply	Durometer	Tensile Strength (psi)	Elongation (%)	Finish
NDIA	D 2000 M2BC 607 A14 B14 F17	-20°F to +180°F	1 & 2	55-65	1015	300	Plate

## ORDERING INFORMATION:

Part Number	Gauge x Width (in)	Avg. Length (Linear ft/Roll)	Approx. lbs/Roll
NDIA-1P02X48X50	1/16 x 48	50	66
NDIA-2P04X48X50	1/8 x 48	50	167
NDIA-2P06X48X50	3/16 x 48	50	221
NDIA-2P08X48X50	1/4 x 48	50	289





## NITRILE SHEET

### General Properties of Nitrile†

- Excellent resistance to petroleum-based fluids.
- Good physical properties.

† Properties shown based on Rubber Manufacturers Association Sheet Rubber Handbook, second edition.

### SPECIFICATIONS:

**Commercial grade black nitrile sheet:**

**Style B60:** 60 Duro hardness (Shore Durometer A)

**Style B70:** 70 Duro hardness (Shore Durometer A)

**Polymer:** Nitrile-Butadiene

**Common Name:** Nitrile, Buna-N

**ISO/ASTM Designation:** NBR

**Talc Free**

Style	ASTM Specification (SI units)	Temp. Range	Durometer	Tensile Strength (psi)	Elongation (%)	Finish
B60	D 2000 M5BG 607 A14 B14 E034	-30°F to +200°F	55 – 65	1015	250%	Plate
B70	D 2000 M5BG 707 A14 B14 E034	-30°F to +200°F	65 – 75	1000	350%	Plate

### ORDERING INFORMATION:

Part Number	Gauge x Width (in)	Avg. Length (Linear ft/Roll)	Approx. lbs/Roll
B60-01x36x67	1/32 x 36	67	56
B60-02x36x67	1/16 x 36	67	100
B60-02x36x100	1/16 x 36	100	149
B60-03x36x67	3/32 x 36	67	150
B60-04x36x67	1/8 x 36	67	200
B60-04x36x100	1/8 x 36	100	299
B60-06x36x36	3/16 x 36	36	161
B60-06x36x50	3/16 x 36	50	224
B60-08x36x36	1/4 x 36	36	215
B60-08x36x50	1/4 x 36	50	299
B60-02x48x67	1/16 x 48	67	133
B60-02x48x100	1/16 x 48	100	199
B60-03x48x67	3/32 x 48	67	200
B60-04x48x50	1/8 x 48	50	198
B60-04x48x67	1/8 x 48	67	266
B60-06x48x36	3/16 x 48	36	215
B60-06x48x50	3/16 x 48	50	298
B60-08x48x36	1/4 x 48	36	287
B60-08x48x50	1/4 x 48	50	399
B70-04x48x50	1/8 x 48	50	198
B70-04x48x100	1/8 x 48	100	376
B70-06x48x50	3/16 x 48	50	298
B70-08x48x50	1/4 x 48	50	398





## General Properties of Nitrile<sup>†</sup>

- Excellent resistance to petroleum-based fluids.
- Good physical properties.

<sup>†</sup> Properties shown based on Rubber Manufacturers Association Sheet Rubber Handbook, second edition.



## SPECIFICATIONS:

Food grade white nitrile sheet, made from FDA-approved materials (Title 21 Food and Drug S 177.26000)

**Style W60:** 60 Duro hardness (Shore Durometer A)

**Common Name:** Nitrile, Buna-N

**Polymer:** Nitrile-Butadiene

**ISO/ASTM Designation:** NBR

**Talc Free**

Style	ASTM Specification (SI units)	Temp. Range	Durometer	Tensile Strength (psi)	Elongation (%)	Finish
W60	D 2000 M1BG 610	-31°F to +230°F	55 – 65	1450	300%	Plate

## ORDERING INFORMATION:

Part Number	Gauge x Width (in)	Avg. Length (Linear fFt /Roll)	Approx. lbs/Roll
W60-02x36x50	1/16 x 36	50	69
W60-02x36x67	1/16 x 36	67	92
W60-03x36x67	3/32 x 36	67	137
W60-04x36x36	1/8 x 36	36	98
W60-04x36x50	1/8 x 36	50	136
W60-06x36x18	3/16 x 36	18	74
W60-08x36x18	1/4 x 36	18	98
W60-08x36x50	1/4 x 36	50	272
W60-02x48x36	1/16 x 48	36	66
W60-02x48x50	1/16 x 48	50	92
W60-04x48x36	1/8 x 48	36	131
W60-04x48x50	1/8 x 48	50	182
W60-06x48x18	3/16 x 48	18	98
W60-06x48x50	3/16 x 48	50	270
W60-08x48x18	1/4 x 48	18	131
W60-08x48x50	1/4 x 48	50	363





## BLACK CLOTH-INSERTED SBR SHEET

### General Properties of SBR†

- Excellent physical properties.

† Properties shown based on Rubber Manufacturers Association Sheet Rubber Handbook, second edition.

### SPECIFICATIONS:

**Commercial grade black SBR sheet, with cloth reinforcement:**

**Style CI:** 60 Duro hardness (Shore Durometer A)

**Polymer:** Styrene-Butadiene Rubber reinforced with 3.4 oz./sq. yd. nylon fabric

**Common Name:** Cloth-reinforced Black Rubber Sheet

**ISO/ASTM Designation:** SBR

**Talc Free**

Style	ASTM Specification (SI units)	Temp. Range	Ply	Durometer	Tensile Strength (psi)	Elongation (%)	Finish
CI	D 2000 M2AA 603 A13 B13 EA14	-20°F to +170°F	1	55 – 65	435	250%	Plate
CI	D 2000 M2AA 603 A13 B13 EA14	-20°F to +170°F	2	55 – 65	435	250%	Plate
CI	D 2000 M2AA 603 A13 B13 EA14	-20°F to +170°F	3	55 – 65	435	250%	Plate
CI	D 2000 M2AA 603 A13 B13 EA14	-20°F to +170°F	4	55 – 65	435	250%	Plate

### ORDERING INFORMATION:

Part Number	Gauge x Width (in)	Fabric Plies	Avg. Length (Linear ft /Roll)	Approx. lbs/Roll
CI-1P02x48x67	1/16 x 48	1 Ply	67	132
CI-2P04x48x36	1/8 x 48	2 Ply	36	140
CI-2P04x48x50	1/8 x 48	2 Ply	50	194
CI-2P06x48x18	3/16 x 48	2 Ply	18	107
CI-2P06x48x50	3/16 x 48	2 Ply	50	297
CI-2P08x48x18	1/4 x 48	2 Ply	18	140
CI-2P08x48x25	1/4 x 48	2 Ply	25	194
CI-2P08x48x50	1/4 x 48	2 Ply	50	388
CI-3P06x48x18	3/16 x 48	3 Ply	18	107
CI-4P08x48x18	1/4 x 48	4 Ply	18	140

## BLACK SBR SHEET

### General Properties of SBR†

- Good physical properties.

† Properties shown based on Rubber Manufacturers Association Sheet Rubber Handbook, second edition.

### SPECIFICATIONS:

**Commercial grade black SBR sheet:**

**Style BL60:** 65 Duro hardness (Shore Durometer A)

**Polymer:** Styrene-Butadiene

**Common Name:** Black Rubber Sheet

**ISO/ASTM Designation:** SBR

**Talc Free**

Style	ASTM Specification (SI units)	Temp. Range	Durometer	Tensile Strength (psi)	Elongation (%)	Finish
BL60	D 2000 M1AA 604	-13°F to +158°F	60 – 70	600	200%	Plate

### ORDERING INFORMATION:

Part Number	Gauge x Width (in)	Avg. Length (Linear ft/Roll)	Approx. lbs/Roll
BL60-02x48x67	1/16 x 48	67	131
BL60-04x48x36	1/8 x 48	36	140
BL60-08x48x18	1/4 x 48	18	140







## General Properties of SBR†

- Good physical properties.

† Properties shown based on Rubber Manufacturers Association Sheet Rubber Handbook, second edition.

## RED SBR SHEET

Plate  
Finish

Fabric  
Finish

## SPECIFICATIONS:

Commercial grade red SBR sheet, Plate or Fabric Finish:

**Style R75:** 70 Duro hardness (Shore Durometer A)

**Style RF75:** 70 Duro hardness (Shore Durometer A)

**Polymer:** Styrene-Butadiene

**Common Name:** Red Rubber Sheet

**ISO/ASTM Designation:** SBR

Meets D1330 Grade 1

**Talc Free**

Style	ASTM Specification (SI units)	Temp. Range	Durometer	Tensile Strength (psi)	Elongation (%)	Finish
R75	D 2000 M2AA 703 A13	-22°F to +158°F	65 – 75	435	150%	Plate
RF75	D 2000 M2AA 703 A13	-22°F to +158°F	65 – 75	435	150%	Fabric Impression

## ORDERING INFORMATION:

Part Number		Gauge x Width (in)	Avg. Length (Linear ft/Roll)	Approx. lbs/Roll
Plate Finish	Fabric Impression			
R75-02x36x67	RF75-02x36x67	1/16 x 36	67	106
R75-02x72x67		1/16 x 72	67	212
R75-04x36x36	RF75-04x36x36	1/8 x 36	36	114
R75-04x36x50		1/8 x 36	50	158
R75-04x72x36		1/8 x 72	36	228
R75-06x36x36	RF75-06x36x36	3/16 x 36	36	171
R75-08x36x18	RF75-08x36x18	1/4 x 36	18	114
R75-08x36x25		1/4 x 36	25	158
R75-08x36x50		1/4 x 36	50	316
R75-02x48x67	RF75-02x48x67	1/16 x 48	67	141
R75-03x48x67		3/32 x 48	67	211
R75-04x48x36	RF75-04x48x36	1/8 x 48	36	152
R75-04x48x50		1/8 x 48	50	211
R75-06x48x36		3/16 x 48	36	228
R75-08x48x18	RF75-08x48x18	1/4 x 48	18	152
R75-08x48x50		1/4 x 48	50	422





## VITON® SHEET

### General Properties of VITON®

- Excellent resistance to many concentrated acids.
- Excellent resistance to heat.

† Properties shown based on Rubber Manufacturers Association Sheet Rubber Handbook, second edition.

Note: VITON® is a registered trademark of DuPont Dow Elastomers.

### SPECIFICATIONS:

**Commercial grade black VITON® sheet:** Grade A – 66% Fluorine

**Style VI70:** 70 Duro hardness (Shore Durometer A)

**Polymer:** Hexafluoropropylene Vinylidene Fluoride

**Common Name:** Viton

**ISO/ASTM Designation:** FKM

**Talc Free**

Style	ASTM Specification (SI units)	Temp. Range	Durometer	Tensile Strength (psi)	Elongation (%)	Finish
VI70	D 2000 M2HK 707 B37	-14°F to +482°F	70	1015	175%	Plate

### ORDERING INFORMATION:

Part Number	Gauge x Width (in)	Avg. Length (Linear ft /Roll)	Approx. lbs/Roll
VI70-01x36x30	1/32 x 36	30	29
VI70-02x36x10	1/16 x 36	10	19
VI70-02x36x30	1/16 x 36	30	58
VI70-03x36x10	3/32 x 36	10	28
VI70-03x36x30	3/32 x 36	30	85
VI70-04x36x10	1/8 x 36	10	37
VI70-04x36x15	1/8 x 36	15	55
VI70-04x36x30	1/8 x 36	30	110
VI70-06x36x10	3/16 x 36	10	57
VI70-06x36x30	3/16 x 36	30	170
VI70-08x36x10	1/4 x 36	10	74
VI70-08x36x15	1/4 x 36	15	111
VI70-08x36x30	1/4 x 36	30	222
VI70-04X48X15	1/8 x 48	15	73
VI70-08X48X15	1/4 x 48	15	146

## CSM SHEET

### General Properties of CSM

- Excellent resistance to oxidation and outstanding resistance to strong sunlight and ozone.
- Good resistance to general acids, oils and greases.

† Properties shown based on Rubber Manufacturers Association Sheet Rubber Handbook, second edition.

### SPECIFICATIONS:

**CSM rubber sheet:**

**Style HY60:** 60 Duro hardness (Shore Durometer A)

**Polymer:** Chlorosulphonated Polyethylene

**Common Name:** CSM

**ISO/ASTM Designation:** CSM

**Talc Free**

Style	ASTM Specification (SI units)	Temp. Range	Durometer	Tensile Strength (psi)	Elongation (%)	Finish
HY60	D 2000 M1CE 610	-31°F to +257°F	55 – 65	1450	350%	Plate

### ORDERING INFORMATION:

Part Number	Gauge x Width (in)	Avg. Length (Linear ft /Roll)	Approx. lbs/Roll
HY60-02x36x67	1/16 x 36	67	88
HY60-04x36x67	1/8 x 36	67	176
HY60-06x36x36	3/16 x 36	36	142
HY60-08x36x36	1/4 x 36	36	190





## General Properties of EPDM†

- Good ozone, chemical and aging resistance.

† Properties shown based on Rubber Manufacturers Association Sheet Rubber Handbook, second edition.

## SPECIFICATIONS:

### Commercial grade black EPDM sheet:

**Style E60:** 60 Duro hardness (Shore Durometer A)

**Style E80:** 80 Duro hardness (Shore Durometer A)

**Polymer:** Ethylene-Propylene-Diene-Monomer



**Common Name:** Ethylene-Propylene Rubber

**ISO/ASTM Designation:** EPDM

**Talc Free**

Style	ASTM Specification (SI units)	Temp. Range	Durometer	Tensile Strength (psi)	Elongation (%)	Finish
E60	D 2000 M2BA 607 A14 B13 C12	-20°F to +230°F	55 – 65	1160	320%	Plate
E80	D 2000 M1BA 802 B13 C12	-20°F to +230°F	75 – 85	290	100%	Plate

## ORDERING INFORMATION:

Part Number	Gauge x Width (in)	Avg. Length (Linear ft/Roll)	Approx. lbs/Roll
E60-02x36x67	1/16 x 36	67	92
E60-02x36x100	1/16 x 36	100	137
E60-04x36x50	1/8 x 36	50	137
E60-04x36x67	1/8 x 36	67	183
E60-06x36x36	3/16 x 36	36	148
E60-08x36x36	1/4 x 36	36	197
E60-08x36x50	1/4 x 36	50	274
E60-02x48x67	1/16 x 48	67	122
E60-02x48x100	1/16 x 48	100	182
E60-04x48x50	1/8 x 48	50	182
E60-04x48x67	1/8 x 48	67	244
E60-06x48x36	3/16 x 48	36	197
E60-08x48x36	1/4 x 48	36	263
E60-08x48x50	1/4 x 48	50	365
E60-12x48x18	3/8 x 48	18	197
E60-12x48x30	3/8 x 48	30	328
E80-04x36x50	1/8 x 36	50	137
E80-08x36x50	1/4 x 36	50	274
E80-04x48x50	1/8 x 48	50	182
E80-08x48x50	1/4 x 48	50	365



## FDA SILICONE SHEET

### General Properties of Silicone†

- Very good resistance to ozone, UV light and ageing.
- Good physical properties.

† Properties shown based on Rubber Manufacturers Association Sheet Rubber Handbook, second edition.

### SPECIFICATIONS:

**Food grade red silicone sheet: In compliance with FDA 21 CFR Part 177**

**Style SILFG:** 60 Duro hardness (Shore Durometer A)

**Polymer:** Polydimethylsiloxane

**Common Name:** Silicone

**ISO/ASTM Designation:** FE

**Talc Free**

Style	ASTM Specification (SI units)	Temp. Range	Durometer	Tensile Strength (psi)	Elongation (%)	Finish
SILFG	D 2000 M4FC 608 B37 E016 G11 EC 1935/2004	-76°F to +446°F	55 – 65	1450	500%	Plate

### ORDERING INFORMATION:

Part Number	Gauge x Width (in)	Avg. Length (Linear ft /Roll)	Approx. lbs/Roll
SILFG-01x36x35	1/32 x 36	35	22
SILFG-02x36x35	1/16 x 36	35	44
SILFG-03x36x35	3/32 x 36	35	67
SILFG-04x36x35	1/8 x 36	35	89
SILFG-06x36x35	3/16 x 36	35	133
SILFG-08x36x35	1/4 x 36	35	178
SILFG-02x48x35	1/16 x 48	35	59
SILFG-04x48x35	1/8 x 48	35	118
SILFG-06x48x35	3/16 x 48	35	178
SILFG-08x48x35	1/4 x 48	35	237

**Note:** The SIL60 product is discontinued. Please call for availability of remaining stock.

## RED PURE GUM SHEET

### General Properties of Red Gum†

- Excellent physical properties.
- High abrasion-resistance.
- Good resilience.

† Properties shown based on Rubber Manufacturers Association Sheet Rubber Handbook, second edition.

### SPECIFICATIONS:

**Red pure gum rubber sheet:**

**Style RG45:** 45 Duro hardness (Shore Durometer A)

**Polymer:** Isoprene rubber (natural)

**Common Name:** Natural Rubber Sheet

**ISO/ASTM Designation:** NR

**ASTM Specification Temp. Tensile Strength Elongation**

**Talc Free**

Style	ASTM Specification (SI units)	Temp. Range	Durometer	Tensile Strength (psi)	Elongation (%)	Finish
RG45	D 2000 M4AA 414 A13 B13 G21	-40°F to +185°F	40 – 50	2050	400%	Plate

### ORDERING INFORMATION:

Part Number	Gauge x Width (in)	Avg. Length (Linear ft/Roll)	Approx. lbs/Roll
RG45-04x48x36	1/8 x 48	36	94
RG45-08x48x25	1/4 x 48	25	137
RG45-12x48x25	3/8 x 48	25	205
RG45-16x48x25	1/2 x 48	25	273
RG45-24x48x25	3/4 x 48	25	410
RG45-32x48x25	1 x 48	25	546





## General Properties of Pure Gum†

- Excellent physical properties.
- Excellent abrasion-resistance.
- Excellent low temperature resistance.
- Good resistance to most acids.

† Properties shown based on Rubber Manufacturers Association Sheet Rubber Handbook, second edition.



## SPECIFICATIONS:

### Tan pure gum rubber sheet:

**Style GF40:** 40 Duro hardness (Shore Durometer A)

**Polymer:** Isoprene rubber (natural)

**Common Name:** Natural Rubber Sheet

**ISO/ASTM Designation:** NR

**Talc Free**

Style	ASTM Specification (SI units)	Temp. Range	Durometer	Tensile Strength (psi)	Elongation (%)	Finish
GF40	D 2000 M4AA 421 A13 B13 G21	-40°F to +176°F	35 – 45	3050	600%	Plate

## ORDERING INFORMATION:

Part Number	Gauge x Width (in)	Avg. Length (Linear ft/Roll)	Approx. lbs/Roll
GF40-02x36x67	1/16 x 36	67	65
GF40-04x36x50	1/8 x 36	50	99
GF40-04x36x67	1/8 x 36	67	131
GF40-06x36x50	3/16 x 36	50	149
GF40-06x36x67	3/16 x 36	67	196
GF40-08x36x36	1/4 x 36	36	140
GF40-08x36x50	1/4 x 36	50	199
GF40-12x36x36	3/8 x 36	36	211
GF40-12x36x50	3/8 x 36	50	298
GF40-16x36x18	1/2 x 36	18	140
GF40-24x36x18	3/4 x 36	18	211
GF40-32x36x18	1 x 36	18	281
GF40-02x48x67	1/16 x 48	67	87
GF40-04x48x36	1/8 x 48	36	94
GF40-04x48x50	1/8 x 48	50	131
GF40-06x48x36	3/16 x 48	36	140
GF40-06x48x50	3/16 x 48	50	199
GF40-08x48x18	1/4 x 48	18	94
GF40-08x48x50	1/4 x 48	50	265
GF40-12x48x50	3/8 x 48	50	397
GF40-16x48x25	1/2 x 48	25	264
GF40-24x48x25	3/4 x 48	25	397
GF40-32x48x25	1 x 48	25	530

\* GF40 is being replaced by GF490. See page 14 for specifications. GF40 will still be available as a special order item. Contact KOA for price and minimum.





**NEW**

## General Properties of Pure Gum†

- Excellent physical properties.
- Excellent abrasion-resistance.
- Excellent low temperature resistance.
- Good resistance to most acids.

† Properties shown based on Rubber Manufacturers Association Sheet Rubber Handbook, second edition.



## SPECIFICATIONS:

**Tan pure gum rubber sheet:**

**Style GF40:** 40 Duro hardness (Shore Durometer A)

**Polymer:** Isoprene rubber (natural)

**Common Name:** Natural Rubber Sheet

**ISO/ASTM Designation:** NR

**Talc Free**

Style	ASTM Specification (SI units)	Temp. Range	Durometer	Tensile Strength (psi)	Elongation (%)	Finish
GF490	D 2000 M4AA 417 A13 B13 G21	-40°F to +176°F	35 – 45	2500	600%	Plate

## ORDERING INFORMATION:

Part Number	Gauge x Width (in)	Avg. Length (Linear ft/Roll)	Approx. lbs/Roll
GF490-02x36x67	1/16 x 36	67	68
GF490-04x36x50	1/8 x 36	50	102
GF490-04x36x67	1/8 x 36	67	137
GF490-06x36x50	3/16 x 36	50	153
GF490-06x36x67	3/16 x 36	67	205
GF490-08x36x36	1/4 x 36	36	147
GF490-08x36x50	1/4 x 36	50	204
GF490-12x36x36	3/8 x 36	36	221
GF490-16x36x18	1/2 x 36	18	147
GF490-24x36x18	3/4 x 36	18	221
GF490-32x36x18	1 x 36	18	294
GF490-01x48x67	1/32 x 48	67	46
GF490-02x48x67	1/16 x 48	67	91
GF490-04x48x36	1/8 x 48	36	98
GF490-04x48x50	1/8 x 48	50	136
GF490-06x48x36	3/16 x 48	36	147
GF490-06x48x50	3/16 x 48	50	204
GF490-08x48x18	1/4 x 48	18	98
GF490-08x48x50	1/4 x 48	50	273
GF490-12x48x50	3/8 x 48	50	409
GF490-16x48x25	1/2 x 48	25	273
GF490-24x48x25	3/4 x 48	25	409
GF490-32x48x25	1 x 48	25	545





## BLACK “V” CORRUGATED PREMIUM RUBBER MATTING

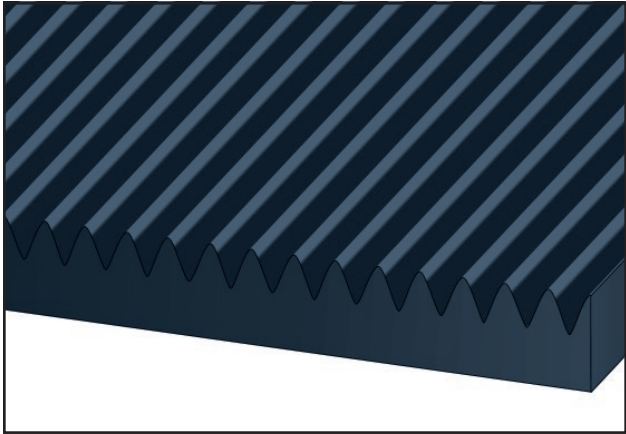

### SPECIFICATIONS: Blended SBR/Natural Rubber

Provides floor protection in entrances and hallways in offices and plants. “V” corrugation allows for easy cleaning.

### ORDERING INFORMATION:

Part Number	Gauge x Width (in)	Temp. Range	Avg. Length (Linear ft/Roll)	Approx. lbs/Roll
MAT-04x24x75	1/8 x 24	-13°F to +158°F	75	101
MAT-04x36x75	1/8 x 36	-13°F to +158°F	75	152
MAT-04x48x75	1/8 x 48	-13°F to +158°F	75	203

## BLACK WIDE-RIBBED PREMIUM RUBBER MATTING



### SPECIFICATIONS: Made with a blend of SBR/Natural Rubber for tough, long lasting service.

This premium wide-ribbed rubber matting is ideal for many uses:

- Factory work stations
- Hallway runners
- Protective covering for carpets

### Features:

- Easy to maintain
- Easy to clean:
  - Wet Mop
  - Garden Hose
  - Household Broom
  - Vacuum Cleaner

### ORDERING INFORMATION:

Part Number	Gauge x Width (in)	Temp. Range	Avg. Length (Linear ft/Roll)	Approx. lbs/Roll
EZMAT-04x24x75	1/8 x 24	-13°F to +158°F	75	111
EZMAT-04x36x75	1/8 x 36	-13°F to +158°F	75	167
EZMAT-04x48x75	1/8 x 48	-13°F to +158°F	75	222



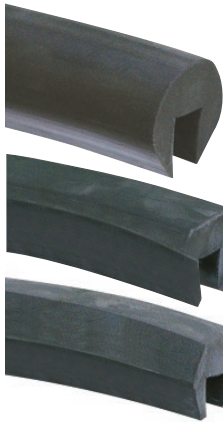

STYLE RTCHNL  
Round Top

STYLE THCHNL  
Tapered Hex  
Flat Top

STYLE HFTCHNL  
Hex Flat Top

## CHANNEL RUBBER STRIP

### SPECIFICATIONS:

Commercial grade black EPDM channel:

Hardness: 65 Duro hardness (Shore Durometer A)

Tensile Strength: 1,650 PSI

Elongation: 310%

This channel rubber strip is ideal for use as a protective edge on shaker screens and a variety of other types of industrial equipment.

#### Standard Round Top Channel

Part Number	Channel Size (in)	Temp. Range	Dimension (in)			
			A	B	C	D
RTCHNL-04x200	1/4	-40°F to +235°F	0.25	0.81	0.44	0.56
RTCHNL-06x200	3/8	-40°F to +235°F	0.38	1.00	0.50	0.50
RTCHNL-08x100	1/2	-40°F to +235°F	0.50	1.25	0.56	0.63
RTCHNL-12x100	3/4	-40°F to +235°F	0.75	1.20	0.63	1.40

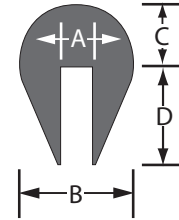

#### Tapered Hex-Flat Top Channel

Part Number	Channel Size (in)	Temp. Range	Dimension (in)			
			A	B	C	D
THCHNL-04x200	1/4	-40°F to +235°F	0.25	0.65	0.38	0.63
THCHNL-06x200	3/8	-40°F to +235°F	0.38	0.85	0.50	0.63
THCHNL-08x100	1/2	-40°F to +235°F	0.50	1.20	0.50	0.69
THCHNL-12x100	3/4	-40°F to +235°F	0.75	1.45	0.50	0.75

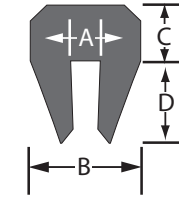

#### Hex-Flat Top Channel

Part Number	Channel Size (in)	Temp. Range	Dimension (in)			
			A	B	C	D
HFTCHNL-04x200	1/4	-40°F to +235°F	0.25	0.75	0.31	0.38
HFTCHNL-06x200	3/8	-40°F to +235°F	0.38	0.88	0.31	0.44
HFTCHNL-08x100	1/2	-40°F to +235°F	0.50	1.00	0.44	0.50
HFTCHNL-12x100	3/4	-40°F to +235°F	0.75	1.25	0.50	0.63

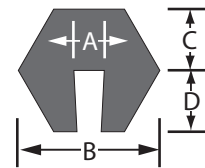

### ORDERING INFORMATION:

Part Number	Channel Size (in)	Roll Length Linear ft	Approx. lbs/Roll
RTCHNL-04x200	1/4	200	50
RTCHNL-06x200	3/8	200	70
RTCHNL-08x100	1/2	100	51
RTCHNL-12x100	3/4	100	70
THCHNL-04x200	1/4	200	44
THCHNL-06x200	3/8	200	64
THCHNL-08x100	1/2	100	48
THCHNL-12x100	3/4	100	62
HFTCHNL-04x200	1/4	200	34
HFTCHNL-06x200	3/8	200	42
HFTCHNL-08x100	1/2	100	44
HFTCHNL-12x100	3/4	100	40







## General Properties of 60 Durometer Skirtboard Rubber

- Excellent abrasion-resistance.
- Excellent weather-resistance

## 60 DUROMETER SKIRTBOARD RUBBER

### SPECIFICATIONS:

Blended SBR/NR slit sheet, Plate Finish:

Style **SK60**: 60 Duro hardness (Shore Durometer A)

Polymer: Styrene-Butadiene and Isoprene Rubber, Natural

**PACKAGING: 50 Ft. Rolls**

Color: Black

Common Name: Skirtboard Rubber

ISO/ASTM Designation: SBR/NR

Style	ASTM Specification (SI units)	Temp. Range	Durometer	Tensile Strength (psi)	Elongation (%)	Finish
SK60	D 2000 M1AA 608	-22°F to +158°F	55 – 65	1050	300%	Plate

### ORDERING INFORMATION:

Part Number	Gauge x Width (in)	Avg. Length (Linear Ft/Roll)	Approx. Lbs/Roll
SK60-08x3x50	1/4 x 3	50	23
SK60-08x4x50	1/4 x 4	50	30
SK60-08x5x50	1/4 x 5	50	38
SK60-08x6x50	1/4 x 6	50	45
SK60-08x8x50	1/4 x 8	50	61
SK60-08x10x50	1/4 x 10	50	76
SK60-08x12x50	1/4 x 12	50	91
SK60-12x3x50	3/8 x 3	50	34
SK60-12x4x50	3/8 x 4	50	45
SK60-12x5x50	3/8 x 5	50	57
SK60-12x6x50	3/8 x 6	50	68
SK60-12x8x50	3/8 x 8	50	91
SK60-12x10x50	3/8 x 10	50	114
SK60-12x12x50	3/8 x 12	50	136
SK60-16x3x50	1/2 x 3	50	45
SK60-16x4x50	1/2 x 4	50	61
SK60-16x5x50	1/2 x 5	50	76
SK60-16x6x50	1/2 x 6	50	91
SK60-16x8x50	1/2 x 8	50	121
SK60-16x10x50	1/2 x 10	50	151
SK60-16x12x50	1/2 x 12	50	182
SK60-24x3x50	3/4 x 3	50	68
SK60-24x6x50	3/4 x 6	50	136
SK60-24x8x50	3/4 x 8	50	182
SK60-24x9x50	3/4 x 9	50	205
SK60-24x10x50	3/4 x 10	50	227
SK60-24x12x50	3/4 x 12	50	273
SK60-32x3x50	1 x 3	50	91
SK60-32x6x50	1 x 6	50	182
SK60-32x8x50	1 x 8	50	242
SK60-32x10x50	1 x 10	50	303
SK60-32x12x50	1 x 12	50	363





## 80 DUROMETER ECONOMY SKIRTBOARD RUBBER

### General Properties of 80 Durometer Skirtboard Rubber

- Excellent abrasion-resistance.
- Excellent weather-resistance.

### SPECIFICATIONS:

**Blended NR slit sheet, Plate Finish:**

**Style ESK80:** 80 Duro hardness (Shore Durometer A)

**Polymer:** Natural and Synthetic Rubber

**Color:** Black

**Common Name:** Skirtboard Rubber

**ISO/ASTM Designation:** NR

### PACKAGING: 50 Ft. Rolls

**Tensile Strength:** 290 PSI

**Elongation:** 100%

#### Applications:

Slit to width for belt wipers, snow plow blades and squeegee use.

Style	ASTM Specification (SI units)	Temp. Range	Durometer	Tensile Strength (psi)	Elongation (%)	Finish
ESK80	D 2000 M1AA 802	-22°F to +158°F	75 – 85	290	100%	Plate

### ORDERING INFORMATION:

Part Number	Gauge x Width (in)	Avg. Length (Linear ft/Roll)	Approx. lbs/Roll
ESK80-16x4x50	1/2 x 4	50	61
ESK80-16x6x50	1/2 x 6	50	91
ESK80-16x8x50	1/2 x 8	50	121
ESK80-24x6x50	3/4 x 6	50	137
ESK80-24x8x50	3/4 x 8	50	182
ESK80-32x6x50	1 x 6	50	182
ESK80-32x8x50	1 x 8	50	243
ESK80-32x10x50	1 x 10	50	303
ESK80-32x12x50	1 x 12	50	364





## SPECIFICATIONS: SBR - Plate Finish

**PACKAGING: 50 Ft. Rolls**

Style **SESK**: 65 Duro hardness (Shore A)

Style	ASTM Specification (SI units)	Temp. Range	Durometer	Tensile Strength (psi)	Elongation (%)	Finish
SESK60	D 2000 M1AA 654	-22°F to +158°F	60 – 70	610	300%	Plate

## ORDERING INFORMATION:

Part Number	Gauge x Width (in)	Avg. Length (Linear ft/Roll)	Approx. lbs/Roll
SESK60-08x3x50	1/4 x 3	50	21
SESK60-08x4x50	1/4 x 4	50	28
SESK60-08x6x50	1/4 x 6	50	43
SESK60-08x8x50	1/4 x 8	50	57
SESK60-08x10x50	1/4 x 10	50	71
SESK60-08x12x50	1/4 x 12	50	85
SESK60-12x2x50	3/8 x 2	50	21
SESK60-12x3x50	3/8 x 3	50	32
SESK60-12x4x50	3/8 x 4	50	42
SESK60-12x6x50	3/8 x 6	50	63
SESK60-12x8x50	3/8 x 8	50	84
SESK60-12x10x50	3/8 x 10	50	105
SESK60-12x12x50	3/8 x 12	50	127
SESK60-16x3x50	1/2 x 3	50	42
SESK60-16x4x50	1/2 x 4	50	56
SESK60-16x5x50	1/2 x 5	50	71
SESK60-16x6x50	1/2 x 6	50	85
SESK60-16x8x50	1/2 x 8	50	113
SESK60-16x10x50	1/2 x 10	50	141
SESK60-16x12x50	1/2 x 12	50	169
SESK60-24x3x50	3/4 x 3	50	63
SESK60-24x4x50	3/4 x 4	50	85
SESK60-24x6x50	3/4 x 6	50	127
SESK60-24x8x50	3/4 x 8	50	165
SESK60-24x10x50	3/4 x 10	50	211
SESK60-24x12x50	3/4 x 12	50	253
SESK60-32x3x50	1 x 3	50	85
SESK60-32x4x50	1 x 4	50	113
SESK60-32x6x50	1 x 6	50	169
SESK60-32x8x50	1 x 8	50	226
SESK60-32x10x50	1 x 10	50	282
SESK60-32x12x50	1 x 12	50	339
SESK60-48x10x50	1 1/2 x 10	50	455



## 48" Wide Economy Skirtboard Slab Rubber

Style	ASTM Specification (SI units)	Temp. Range	Durometer	Tensile Strength (psi)	Elongation (%)	Finish
SESK60	D 2000 M1AA 654	-22°F to +158°F	60 – 70	610	250%	Plate

### ORDERING INFORMATION:

Part Number	Gauge x Width (in)	Avg. Length (Linear ft/Roll)	Approx. lbs/Roll
SESK60-08x48x50	1/4 x 48	50	363
SESK60-12x48x50	3/8 x 48	50	545
SESK60-16x48x50	1/2 x 48	50	727
SESK60-24x48x50	3/4 x 48	50	1090
SESK60-32x48x50	1 x 48	50	1454



## SHEET RUBBER GLOSSARY

**Adhesion:** (1) Basically, the adhering, clinging, bonding or sticking of two material surfaces to one another, such as rubber to rubber, rubber to glass, rubber to metal, rubber to wood, rubber to fabric, rubber to cord, rubber to wire, etc. (2) Refers to the strength of bond between cured rubber surfaces or cured rubber surface and a non-rubber surface.

**Aging:** To undergo changes to physical properties with age or lapse of time.

**Aging, Air Oven:** A means of accelerating the change in physical properties of rubber compounds by exposing them to the action of air at an elevated temperature.

**Ambient Temperature:** The environment temperature surrounding the object under consideration.

**Blemish:** A mark, deformity, or injury which impairs the appearance.

**Blisters:** A raised spot on the surface or a separation between layers usually forming a void or air-filled space in the vulcanized article. (See bubbles, sinks and voids.)

**Bloom:** A coating or efflorescence creating a discoloration or change in appearance of the surface of a rubber product caused by the migration of a liquid or solid to the surface. Examples: Sulfur Bloom, Wax Bloom. Not to be confused with dust on the surface from external sources.

**Calendered:** Continuously sheeted or plied up rubber compound or fabric that is frictioned or coated with rubber compound on a machine equipped with three or more heavy internally heated or cooled rolls revolving in opposite direction.

**Checking:** Short, shallow cracks on the surface, generally due to effect of destructive action of environmental conditions.

**C. I. (Cloth-inserted):** An abbreviation used to indicate a sheet of rubber containing one or more plies of cloth or duck, in which the cloth is completely covered with rubber.

**Cloth Impression:** Same as fabric impression.

**Coating:** A layer of material covering a surface.

**Compression Set:** The deformation which remains in rubber after it has been subjected to and released from a specific compressive stress for a definite period of time at a prescribed temperature. Compression set measurements are made for the purpose of evaluating the creep and stress relaxation properties of rubber.

**Cracking:** A sharp break or fissure in the surface. Generally due to excessive strain.

**Crazing:** A surface effect on rubber articles characterized by multitudinous minute cracks.

**Cure:** The act of vulcanization.

**Curing Temperature:** The temperature at which the rubber is vulcanized.

**Diaphragm Sheet:** Sheet (generally fabric-reinforced rubber) from which flat diaphragms may be cut.

**Die Cut:** Shaped articles punched from a sheet of rubber with a die.

**Dielectric Strength:** The measure of electric potential strength of a rubber product. Measure of its ability as an insulating compound to resist passage of a disruptive discharge produced by an electric stress. Measure as volts per mil of thickness.

**Durometer:** An instrument for measuring the hardness of rubber. Measures resistance to the penetration of an indenter point into the surface of the rubber.

**Durometer Hardness:** An arbitrary numerical value which measures the resistance to penetration of the indenter point of the durometer. Value may be taken immediately or after a very short specified time.

**Elastomer:** Macromolecular material that returns rapidly to approximately the initial dimensions and shape after substantial deformation by a weak stress and release of stress.

**Elongation:** Increase in length expressed numerically as a fraction or percentage of initial length.

**Filler:** (1) A material incorporated into a rubber compound to increase its bulk. (2) A compound built into a rubber product to increase its bulk and/or improve its appearance. (3) Sometimes erroneously used to mean "filling" in textiles.

**Finish, Fabric:** Same as impress, fabric.

**Finish, Paper:** Finish resulting from curing in contact with paper.

**Finish Plate or Platen:** Same as plate finish (sheet).

**Foreign Material:** Any extraneous matter such as wood, paper, metal, sand, dirt or pigment that should not normally be present in a particular rubber product or composition.





## SHEET RUBBER GLOSSARY

**Gauge:** (1) The measure of thickness of the individual elements making up a rubber product. (2) A device for measuring. (See thickness.)

**Grain:** The effect on a rubber compound due to processing it through a tubing machine, calender, or mill.

**Hardness:** Property or extent of being hard. Measured by extent of failure of the indenter point of any one of a number of standard hardness testing instruments to penetrate the product.

**Homogeneity:** Uniformity of composition throughout the material.

**Homogeneous:** Of uniform composition throughout.

**Impression:** Design formed during vulcanization in the surface of any rubber article by a method of transfer, such as fabric impression or molded impression.

**Impression, Fabric:** Impression formed during cure by fabric wrap.

**Laminated:** Built up from thinner layers.

**Modulus:** In the physical testing of rubber, it is the ratio of stress to strain; that is, the load in pounds per square inch or kilograms per square centimeter of initial cross sectional-area necessary to produce a stated percentage elongation. It is a measure of stiffness.

**Non-blooming:** The absence of bloom.

**Oxidation:** The reaction of oxygen on a rubber product, usually detected by a change in the appearance or feel of the surface, or by a change in physical properties.

**Ozone Cracking:** Surface cracks, checks or crazing caused by exposure to an atmosphere containing ozone. (See also ozone resistant.)

**Ozone Resistant:** Withstands the deteriorating effects of ozone, generally cracking.

**Plate Finish (Sheet):** A commercially smooth surface, the usual result of vulcanization between press plates (platens).

**Ply:** (1) A layer of rubberized fabric. (2) A layer consisting of multiple strands of cord or wire close spaced. (3) A single yarn in a composite yarn. (4) Used in processing as a layer of unvulcanized rubber compound.

**Polymer:** A very long chain of units of monomers, prepared by means of an addition and/or condensation polymerization. The units may be the same or different. There are copolymers,

di-polymers, tri or ter polymers, quadri-polymers, high polymers, etc. Natural rubber is a polymer of isoprene.

**Press Length:** The length of a product which can be vulcanized at one time in a press, limited to the length measurement of the press.

**Random Length:** A unit of material which does not fall into any current classification for standard length.

**Relative Humidity:** The ration of the quantity of water vapor actually present in the atmosphere to the greatest amount possible at the given temperature.

**Roll:** Sheet rubber and gasket material of a uniform width rolled up on itself from which gaskets and other products of lesser dimensions and various shapes may be cut.

**Rubber:** A material that is capable of recovering from large deformations quickly and forcibly, and can be, or already is, modified to a state in which it is essentially insoluble (but can swell) in boiling solvent, such as benzene, methyl ethyl ketone, and ethanol-toluene azeotrope.

**Sinks:** A collapsed blister or bubble leaving a depression in the product.

**Slab:** Thick sheet, generally laminated.

**Specific Gravity:** The ratio of the weight of a given substance to the weight of an equal volume of water at a specified temperature.

**Tacky (Rubber Surface):** Tending to adhere.

**Tensile Strength:** The maximum tensile stress applied during stretching a specimen to rupture.

**Viscosity:** A manifestation of internal friction opposed to mobility. The property of fluids and plastic solids by which they resist an instantaneous change of shape, i.e., resistant to flow.

**Volume Swell:** Increase in physical size caused by the swelling action of a liquid.

**Vulcanization:** Act or process of treating an elastomer or compound of same to improve its useful properties, usually accomplished by application of heat.

**Warp:** The yarns that run lengthwise in a woven fabric.

**Waft:** The crosswise threads in a fabric; filling threads. The threads or yarns running at right angle to the warp.





## General properties of common polymers used in sheet rubber

	Neoprene	Nitrile	EPDM	SBR	CI	Pure Gum	Silicone	Viton	CSM
Heat Aging	Good	Good	Excellent	Good	Good	Good	Excellent	Excellent	Good
Abrasion Resistance	Excellent	Excellent	Very Good	Good	Good	Excellent	Poor	Fair	Fair
Compression Set	Fair	Fair	Fair	Good	Good	Good	Fair	Good	Good
Resilience	Excellent	Good	Good	Good	Good	Outstanding	Fair	Fair	Fair
Tear	Good	Good	Good	Fair	Good	Good	Good	Fair	Fair
Flame Resistance	Excellent	Poor	Very Poor	Very Poor	Very Poor	Very Poor	Fair	Good	Good
Weathering	Very Good	Fair	Excellent	Fair	Fair	Fair	Good	Excellent	Excellent
Ozone Resistance	Very Good	Very Poor	Good	Fair	Fair	Poor	Good	Excellent	Excellent
Gas Permeability Resistance	Good	Good	Good	Good	Good	Good	Poor	Poor	Poor
Oil Resistance	Good	Very Good	Very Poor	Poor	Poor	Very Poor	Fair	Good	Fair
Gas Resistance	Good	Excellent	Very Poor	Poor	Poor	Very Poor	Poor	Poor	Poor
Acid Resistance	Good	Good	Good	Fair	Fair	Good	Poor	Good	Good
Alkali Resistance	Good	Good	Good	Fair	Fair	Good	Poor	Good	Good

## TAKE NOTE!

The general properties shown in the chart above are not intended to be used to make final choices for a specific application. Exposure to heat, sunlight, chemicals, ozone and oils, as well as pressure, tension, binding, stretching and folding, will affect the performance of a rubber product.

Suitability must be determined by a qualified person. See Cautionary Statement on the next page.

## Sheet Rubber Tolerances

(Tolerances conform to RMA standards, Durometer  $\pm$  5 points.)

Thickness	Tolerance	Thickness	Tolerance
1/32" but not including 1/16" .....	$\pm$ .012"	9/16" but not including 3/4" .....	$\pm$ .062"
1/16" but not including 1/8" .....	$\pm$ .016"	3/4" but not including 1" .....	$\pm$ .094"
1/8" but not including 3/16" .....	$\pm$ .020"	1" and Over .....	$\pm$ 10%
3/16" but not including 3/8" .....	$\pm$ .031"	<b>Width</b>	<b>Tolerance</b>
3/8" but not including 9/16" .....	$\pm$ .047"	36" and over .....	$\pm$ 1.00"





## Recommended Shelf Life for Sheet Rubber

Common Polymer Name	Recommended Shelf Life
Viton / Silicone	20 Years
Nitrile / Neoprene	5-10 Years
EPDM / CSM	5-10 Years
Natural Rubber (Pure Gum)	3-5 Years
SBR	3-5 Years

Shelf life may be affected if storage factors listed below are different than the guidelines shown by the Rubber Manufacturers Association.

### Storage of Rubber Products<sup>†</sup>

Rubber products in storage can be adversely affected by such factors as temperature, ozone, sunlight, oils, solvents, corrosive liquids and fumes, insects and rodents, and radiation.

The warehousing area should be relatively cool, dark and free from dampness and mildew. All items should be stored on a first-in first-out basis, since even under these conditions an unusually long period of storage could deteriorate certain rubber products.

The ideal storage temperature for rubber products is 50° to 70° F (10° to 21° C), with a maximum limit of 100° F (38° C). If stored below 32° F (0° C), some products may become stiff and should be warmed before being placed in service. Rubber products should not be stored near sources of heat, such as radiators and baseboard heaters.

Rubber products should not be stored under conditions of high or low humidity.

To protect against the adverse effects of ozone, rubber products should not be stored near electrical equipment that may generate ozone and should not be stored for any lengthy period of time in geographical areas known to be high in ozone. Conditions of direct or reflected sunlight should also be avoided.

Whenever feasible, rubber products should be stored in their original shipping containers, especially when such containers are wooden crates or cardboard cartons, since this will provide protection against the deteriorating effects of oils, solvents and corrosive liquids, as well as affording some protection against ozone and sunlight.

Because certain rodents and insects thrive on rubber products, adequate protection from them should be provided.

**† Based on information from Rubber Manufacturers Association Sheet Rubber Handbook, second edition.**











# Cautionary Statement

All Products sold and distributed by Kuriyama of America, Inc. are in the nature of commodities and they are sold by published specifications and not for particular purposes, uses or applications. Purchaser shall first determine their suitability for the intended purposes, uses or applications and shall either conduct its own engineering studies or tests, or retain qualified engineers, consultants or testing laboratories and consult with them before determining the proper use, suitability or propriety of the merchandise or Products for the intended purposes, uses or applications.

Kuriyama of America, Inc. ("Seller") does not recommend the Products for any particular purpose, use or application, and the Purchaser or user thereof shall assume full responsibility for the suitability, propriety, use and application of the Products. Purchaser shall follow all instructions contained in Seller's catalogs, brochures, technical bulletins and other documents regarding the Products. The Products, including but not limited to, hose, tubing or couplings, may fail due to the use or conveyance of substances at elevated or lowered temperatures or at excessive pressure, the conveyance of abrasive, injurious, flammable, explosive or damaging substances.

Hose or tubing used in bent configurations will be subjected to increased abrasion. Hose clamps or couplings may loosen after initial installation and all sections of hose and tubing including connections, couplings, clamps, conductivity and bonding should be inspected frequently, regularly and consistently, and should be replaced, adjusted or re-tightened for the avoidance of leakage, for the prevention of injuries or damages, and for general safety purposes. Except as indicated in its Limited Warranty, Seller shall not be liable or responsible for direct or indirect injuries or damages caused by or attributed to the failure or malfunction of any Products sold or distributed by it.

Purchasers or users of the Products should frequently and consistently undertake inspections and protective measures with respect to the use and application of Products, which should include the examination of tube and cover, conditions of the hose or tubing, and the identification, repair or replacement of sections showing cracking, blistering, separations, internal and external abrasions, leaking or slipped couplings or connections and make proper proof tests.

## Limited Warranty

The Products sold or distributed by Seller are warranted to its customers to be free from defects in material and workmanship at the time of shipment by us, subject to the following provisions. ALL WARRANTY CLAIMS SHALL BE MADE WITHIN SIX (6) MONTHS AFTER SELLER SHIPPED THE PRODUCTS. SELLER'S LIABILITY HEREUNDER IS LIMITED AT SELLER'S EXCLUSIVE DISCRETION, TO 1) THE PURCHASE PRICE OF ANY PRODUCTS PROVING DEFECTIVE; 2) REPAIR OF ANY DEFECTIVE PRODUCT OR PART THEREOF; OR 3) REPLACEMENT OF ANY DEFECTIVE PRODUCT OR PART UPON ITS AUTHORIZED RETURN TO SELLER.

THIS WARRANTY IS IN LIEU OF AND EXCLUDES ALL OTHER WARRANTIES, EXPRESSED, IMPLIED, STATUTORY, OR OTHERWISE CREATED UNDER APPLICABLE LAW INCLUDING, BUT NOT LIMITED TO, THE WARRANTY OF MERCHANTABILITY AND THE WARRANTY OF FITNESS FOR A PARTICULAR PURPOSE. IN NO EVENT SHALL SELLER OR THE MANUFACTURER OF THE PRODUCT BE LIABLE FOR SPECIAL, INCIDENTAL, OR CONSEQUENTIAL DAMAGES, INCLUDING LOSS OF PROFITS, WHETHER OR NOT CAUSED BY OR RESULTING FROM THE NEGLIGENCE OF SELLER AND/OR THE MANUFACTURER OF THE PRODUCT, UNLESS SPECIFICALLY PROVIDED HEREIN. IN ADDITION, THIS WARRANTY SHALL NOT APPLY TO ANY PRODUCTS OR PORTIONS THEREOF WHICH HAVE BEEN SUBJECTED TO ABUSE, MISUSE, IMPROPER INSTALLATION, MAINTENANCE, OR OPERATION, ELECTRICAL FAILURE OR ABNORMAL CONDITIONS, AND TO PRODUCTS WHICH HAVE BEEN TAMPERED WITH, ALTERED, MODIFIED, REPAIRED, REWORKED BY ANYONE NOT APPROVED BY SELLER, OR USED IN ANY MANNER INCONSISTENT WITH THE PROVISIONS OF THE "CAUTIONARY STATEMENT" ABOVE OR ANY INSTRUCTIONS OR SPECIFICATIONS PROVIDED WITH OR FOR THE PRODUCT. 09/17/18 REV

Distributed by:



## Kuriyama of America, Inc.

Headquarters, Sales Office and Warehouse Location

360 E. State Parkway, Schaumburg, IL 60173-5335  
Phone: (847) 755-0360 • Toll-free FAX: (800) 800-0320  
International FAX: (847) 885-0996

Web Site: [www.kuriyama.com](http://www.kuriyama.com)  
E-Mail: [sales@kuriyama.com](mailto:sales@kuriyama.com)



The trademarks contained in this publication are trademarks of Kuriyama of America, Inc.

## CONTACT OUR SALES/WAREHOUSE LOCATIONS BELOW WHICH SERVE YOUR AREA

**SOUTHWEST WAREHOUSE**  
KURIYAMA OF AMERICA, INC.  
HOUSTON  
200 PORTWALL STREET, SUITE 100  
HOUSTON, TX 77029  
Phone: (713) 674-8212  
Toll Free Phone: (800) 501-6808  
FAX: (713) 674-5214  
Toll Free FAX: (800) 800-5214

**WESTERN WAREHOUSE**  
KURIYAMA OF AMERICA, INC.  
SANTA FE SPRINGS  
10749 SHOEMAKER AVENUE  
SANTA FE SPRINGS, CA 90670-4039  
Phone: (562) 941-4507  
FAX: (562) 941-8940  
Toll-Free FAX: (800) 326-8940

**SOUTHEAST WAREHOUSE**  
FORTNEY SALES CO., INC.  
4221 CANTRELL ROAD NW  
ACWORTH, GA 30101  
Phone: (770) 427-6528  
FAX: (770) 423-9249  
Toll Free FAX: (800) 423-9249  
Web Site: [www.fortneysales.com](http://www.fortneysales.com)  
E-Mail: [sales@fortneysales.com](mailto:sales@fortneysales.com)

**EASTERN WAREHOUSE**  
EASTERN RUBBER & PLASTICS CO., INC.  
100 GOLDMAN DR.  
PLUMSTED INDUSTRIAL PARK  
CREAM RIDGE, NJ 08514  
Phone: (609) 758-0100  
FAX: (609) 758-0102  
Toll Free FAX: (800) 445-7138  
Web Site: [www.easternrubber.com](http://www.easternrubber.com)  
E-Mail: [sales@easternrubber.com](mailto:sales@easternrubber.com)

**IN MEXICO:**  
KURIYAMA DE MÉXICO S DE RL DE CV  
AV JOSE PALOMO MARTINEZ NO 520-20  
BODEGA 5  
PARQUE INDUSTRIAL OMOLAP  
APODACA, N.L. CP:66633, MÉXICO  
Telefonos: (81) 1086-1870 O 71  
Lada sin Costo 01 800 822 52 00  
FAX: (81) 1086-1869  
Internet: [www.kuriyama.com](http://www.kuriyama.com)  
Correo Electronico: [ventas@kuriyama.com](mailto:ventas@kuriyama.com)



Visit us  
[www.kuriyama.com](http://www.kuriyama.com)  
on the Web!